

LAUNDRY CABINET

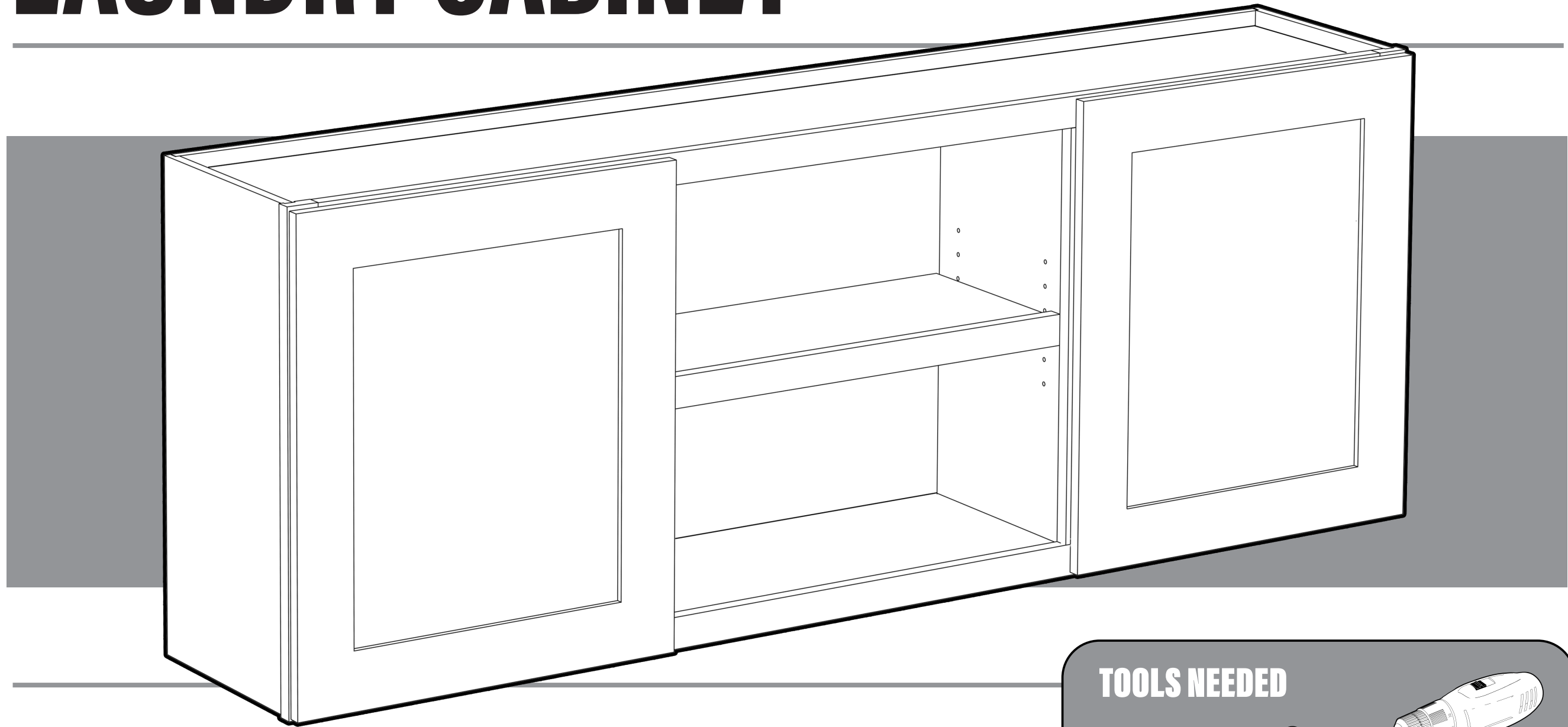

An easy to assemble utility cabinet, perfect for the laundry room or additional storage for the garage or storage room.

TOOLS NEEDED

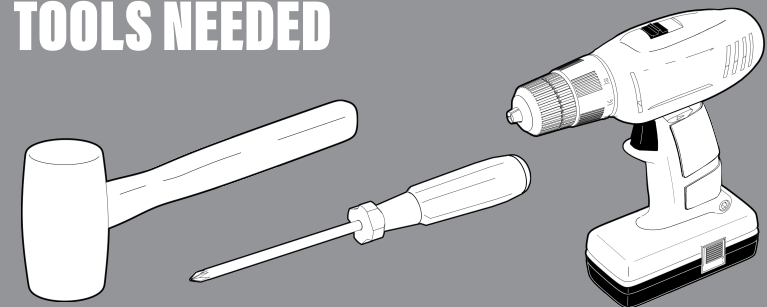

STEP 1

Parts List

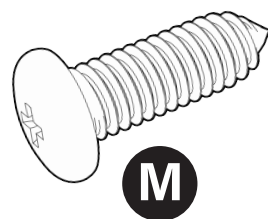

16 - #6 x 1/2" Pan Head Screws

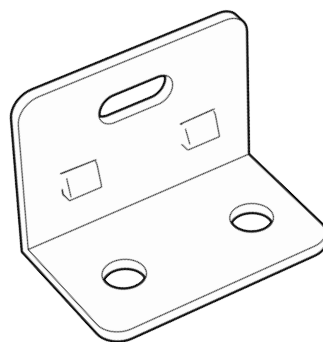

8 - Connector L-Brackets

TOOLS NEEDED

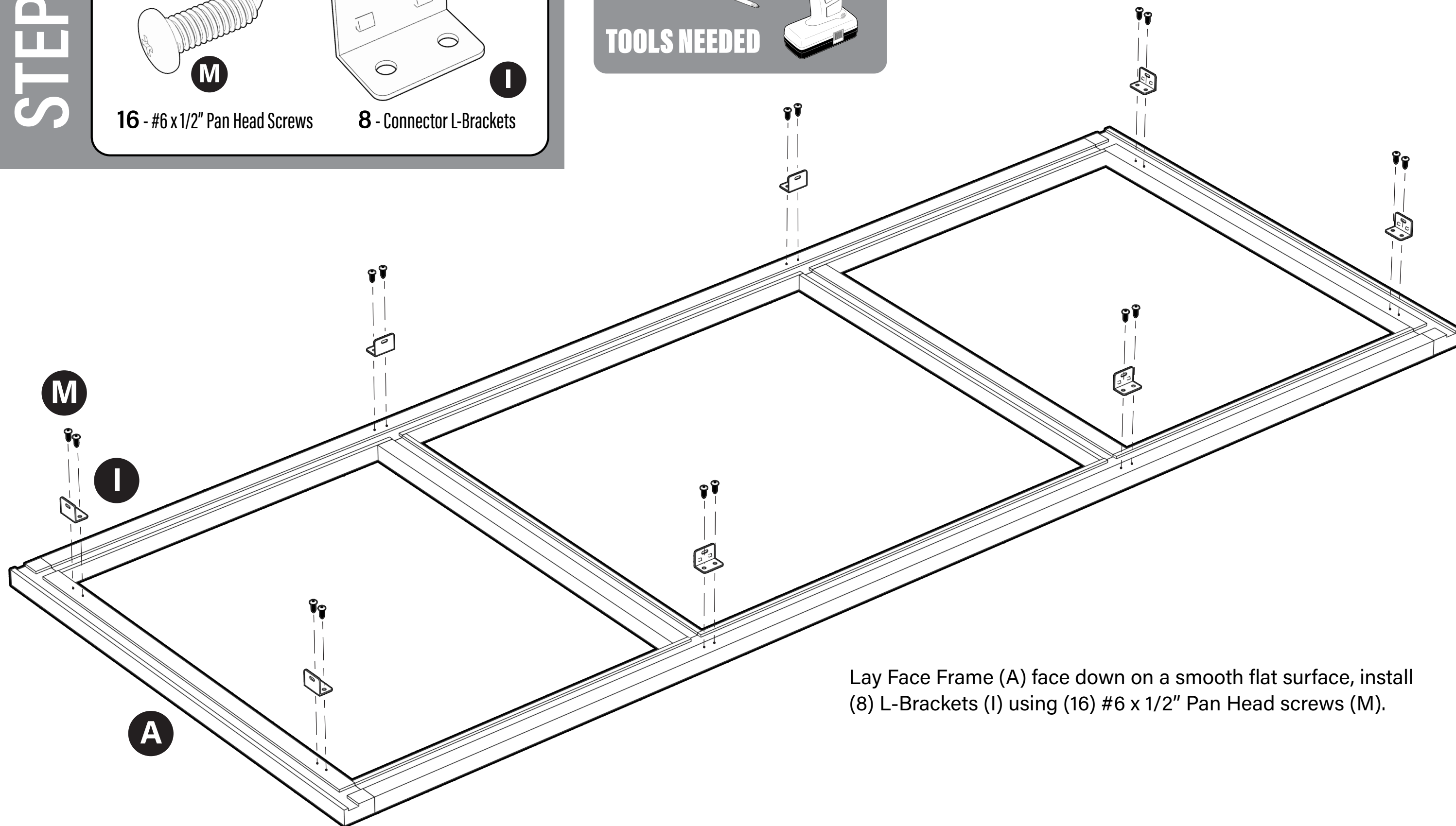
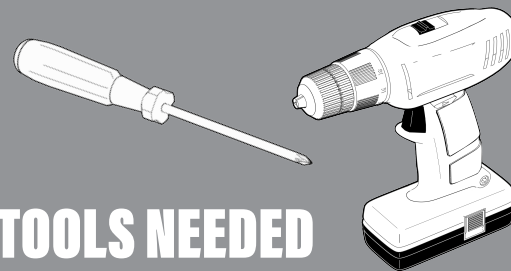

Lay Face Frame (A) face down on a smooth flat surface, install (8) L-Brackets (I) using (16) #6 x 1/2" Pan Head screws (M).

STEP 2

Parts List

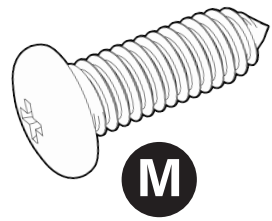

16 - #6 x 1/2" Pan Head Screws

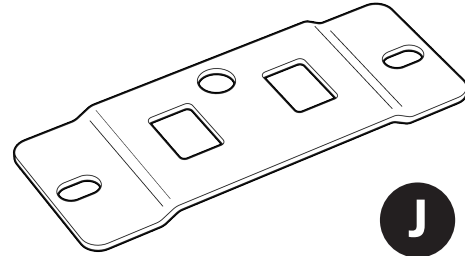

8 - Connector Plates

TOOLS NEEDED

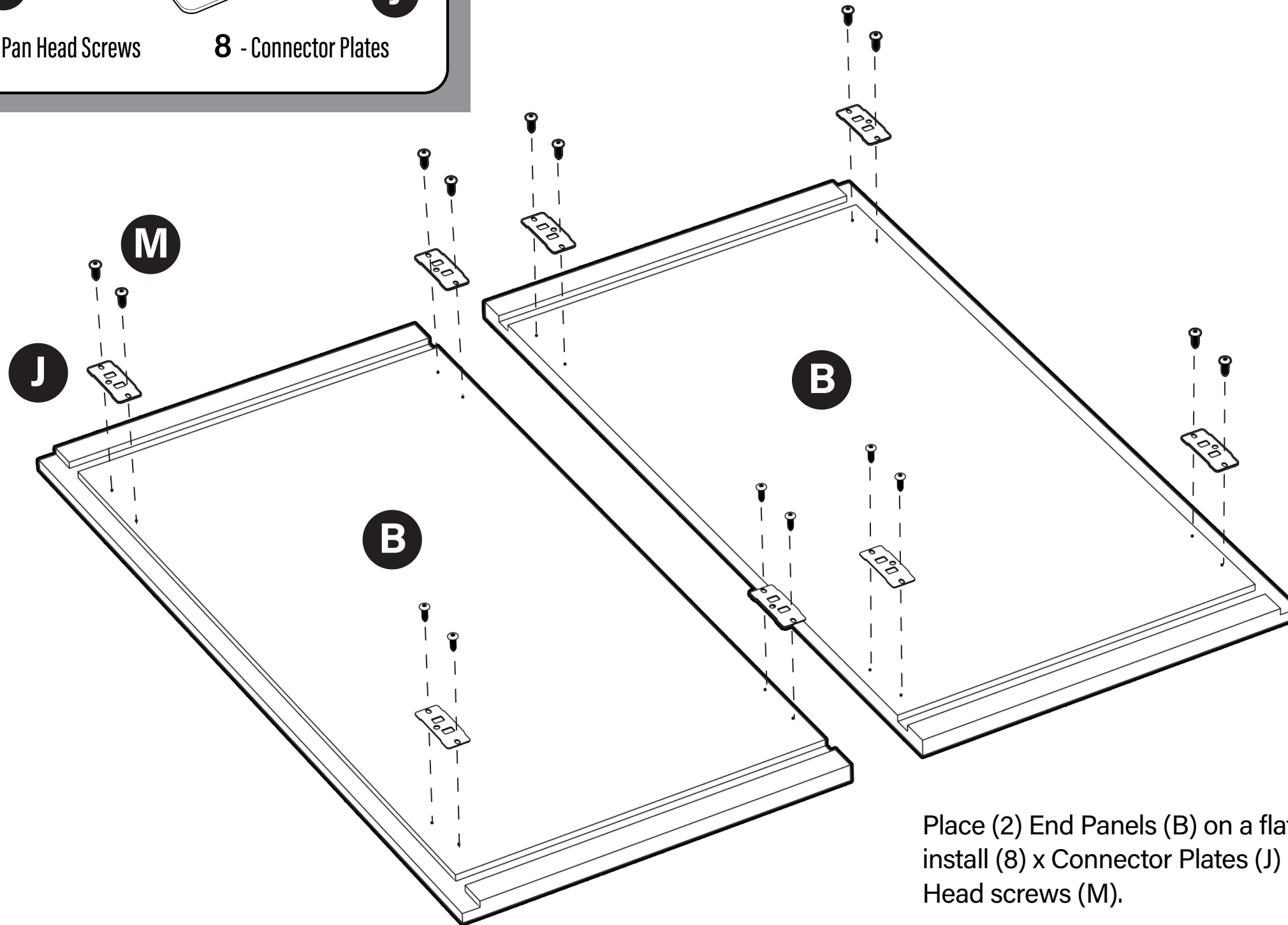
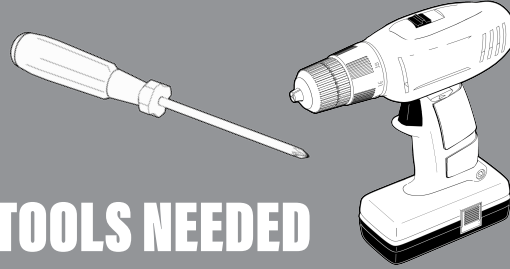

Place (2) End Panels (B) on a flat smooth surface and install (8) x Connector Plates (J) using (16) #6 x 1/2" Pan Head screws (M).

**** Do not fully tighten the screws until connected to the L-brackets!**

STEP 3

Parts List

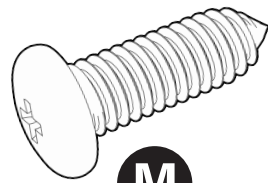

4 - #6 x 1/2" Pan Head Screws

TOOLS NEEDED

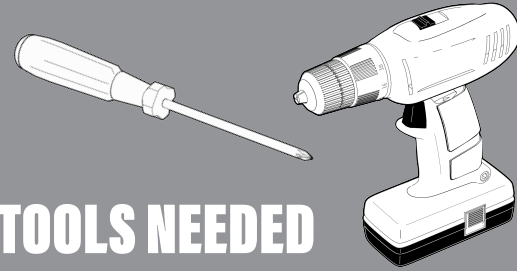

Insert (2) End Panels (B) into outer grooves in Face Frame (A), so that L-Brackets & Connector Plates snap together. Align the panels and tighten the Connector Plate screws. Lock in place using (4) locking screws: #6 x 1/2" Pan Head (M).

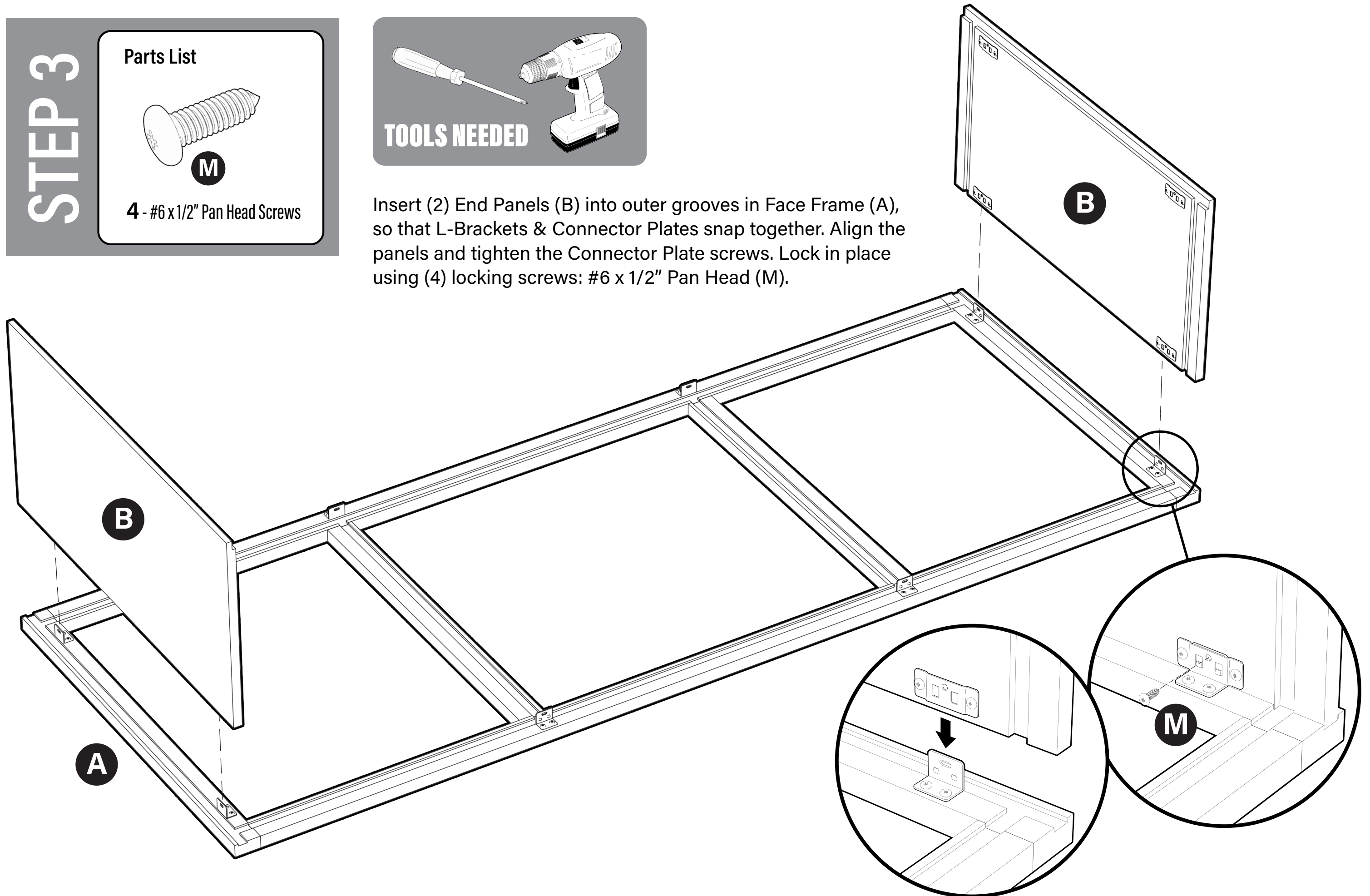

STEP 4

Parts List

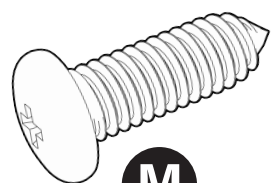

M

8 - #6 x 1/2" Pan Head Screws

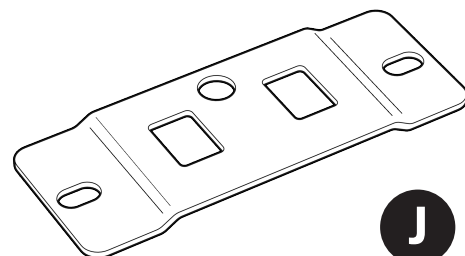

J

4 - Connector Plates

TOOLS NEEDED

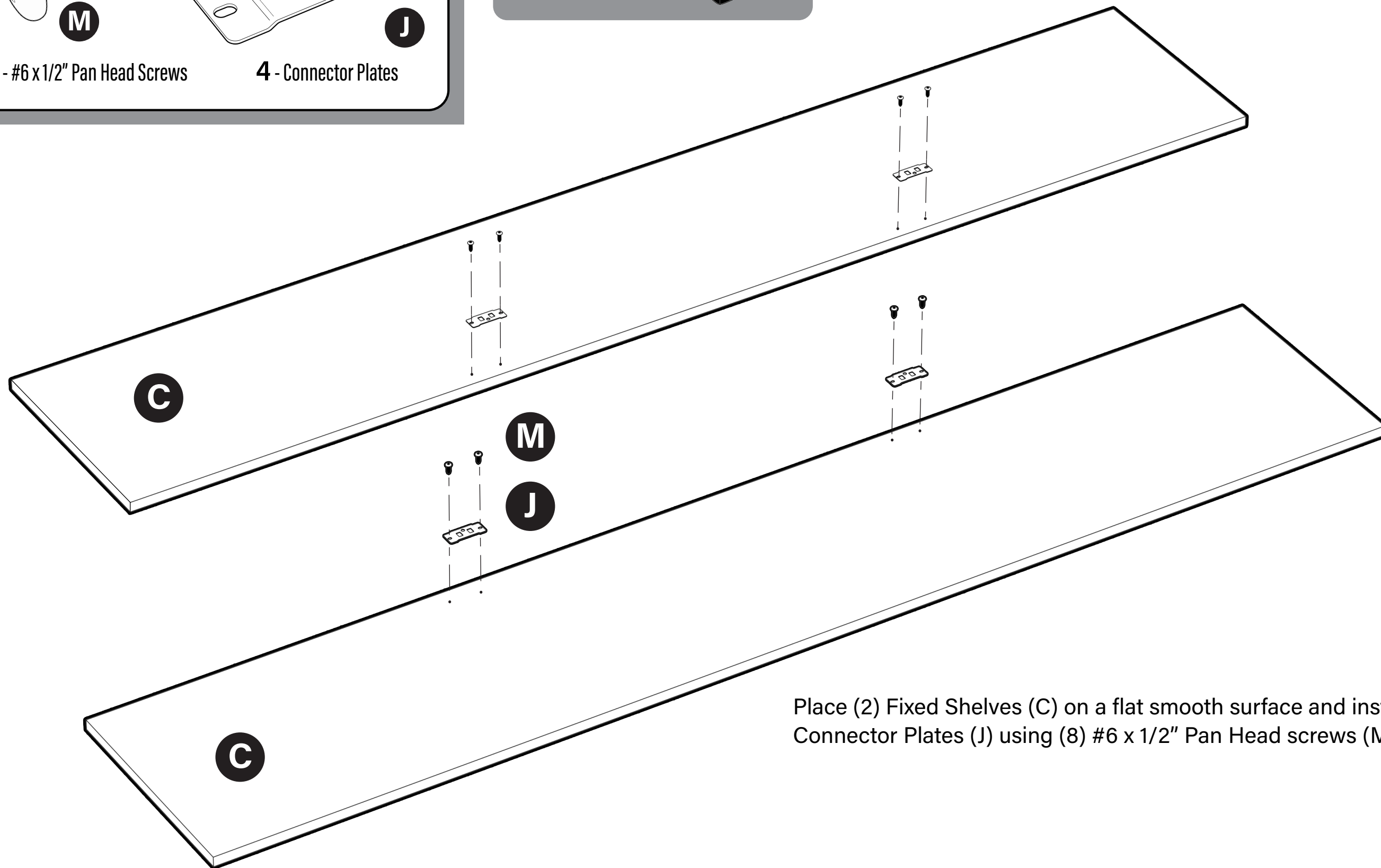
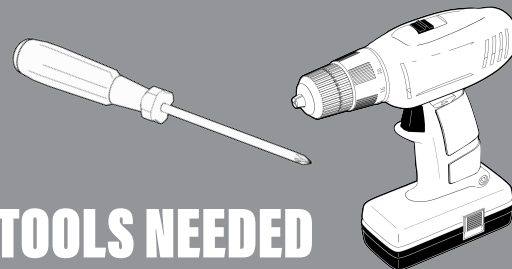

Place (2) Fixed Shelves (C) on a flat smooth surface and install (4) Connector Plates (J) using (8) #6 x 1/2" Pan Head screws (M).

STEP 5

Parts List

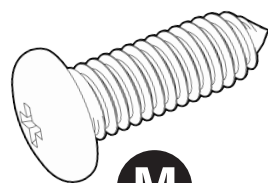

4 - #6 x 1/2" Pan Head Screws

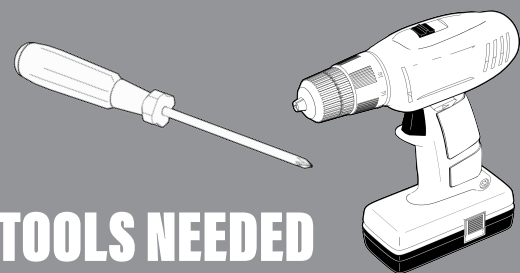

TOOLS NEEDED

Slide (2) Fixed Shelves (C) into grooves in End Panels (B) and Face Frame (A) so that L-Brackets & Connector Plates snap in place, Align the panels and tighten the Connector Plate screws. Lock in place using (4) locking screws: #6 x 1/2" Pan Head screws (M).

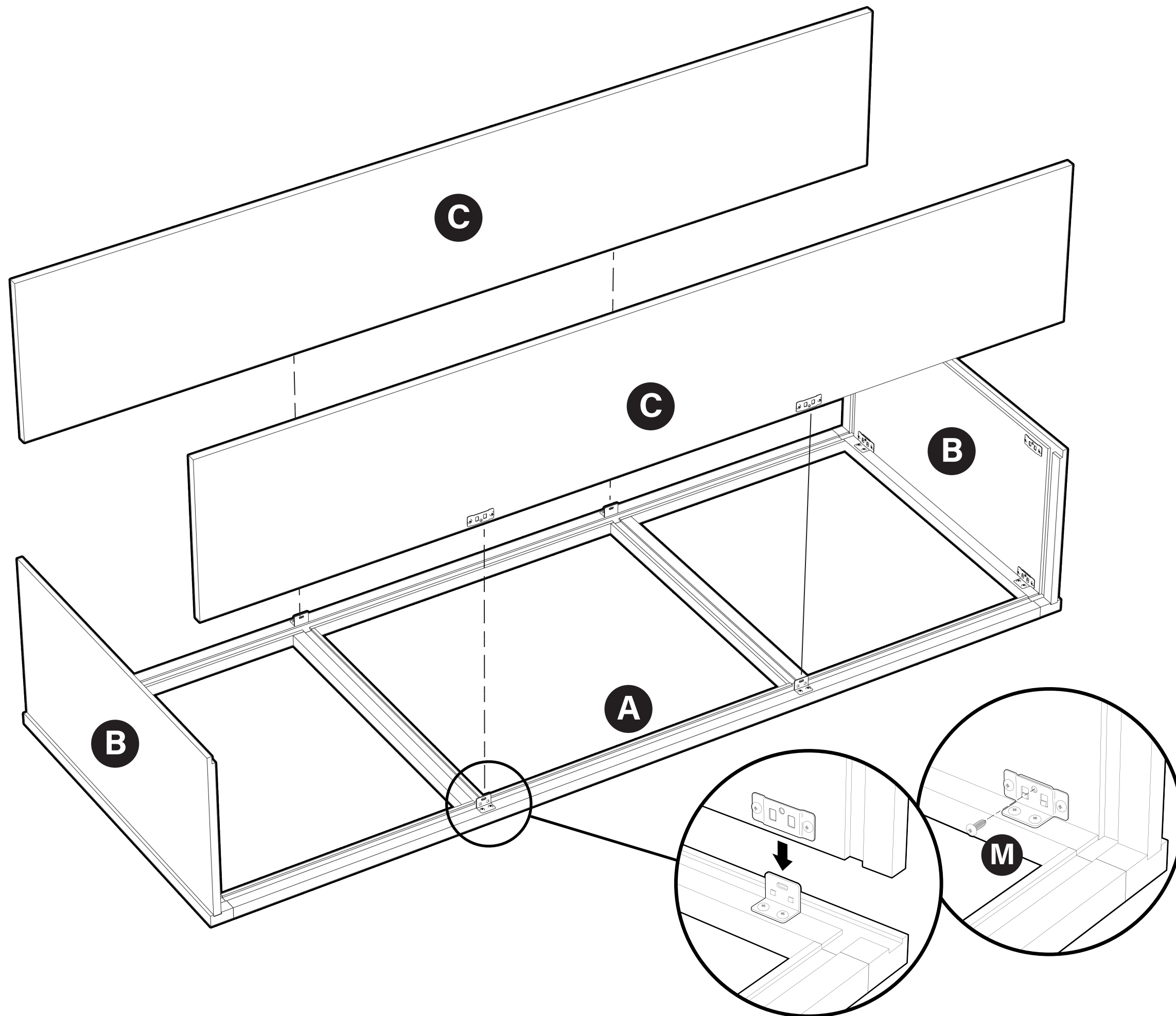

STEP 6

Parts List

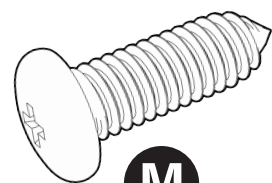

M

8 - #6 x 1/2" Pan Head Screws

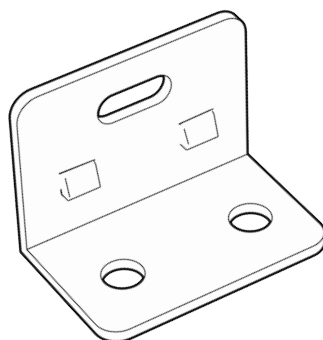

I

4 - Connector L-Brackets

TOOLS NEEDED

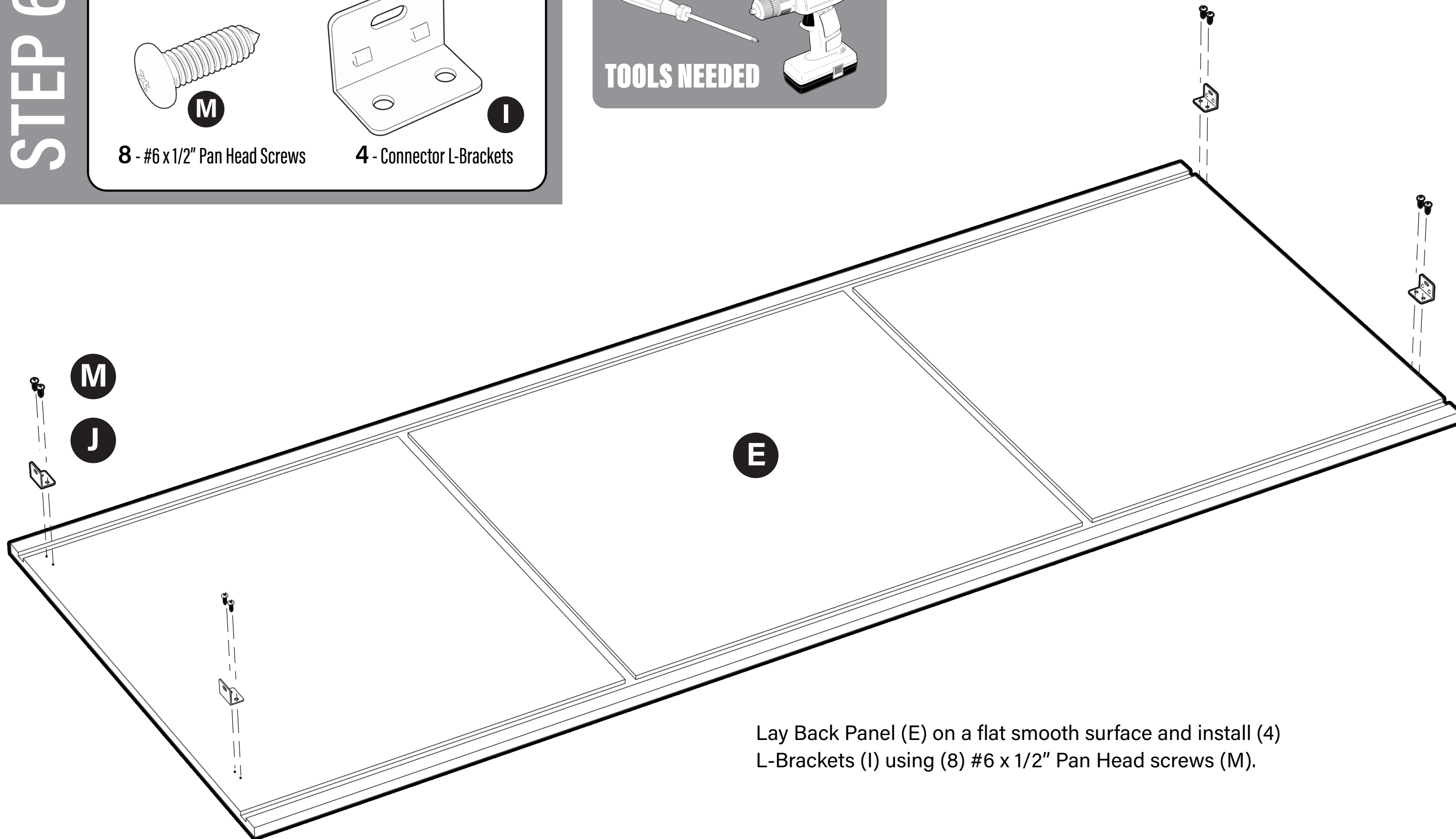
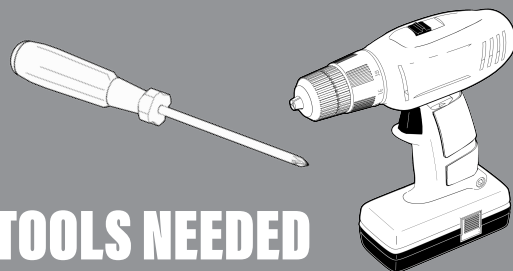

Lay Back Panel (E) on a flat smooth surface and install (4) L-Brackets (I) using (8) #6 x 1/2" Pan Head screws (M).

STEP 7

Parts List

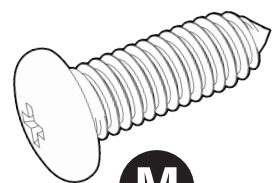

4 - #6 x 1/2" Pan Head Screws

TOOLS NEEDED

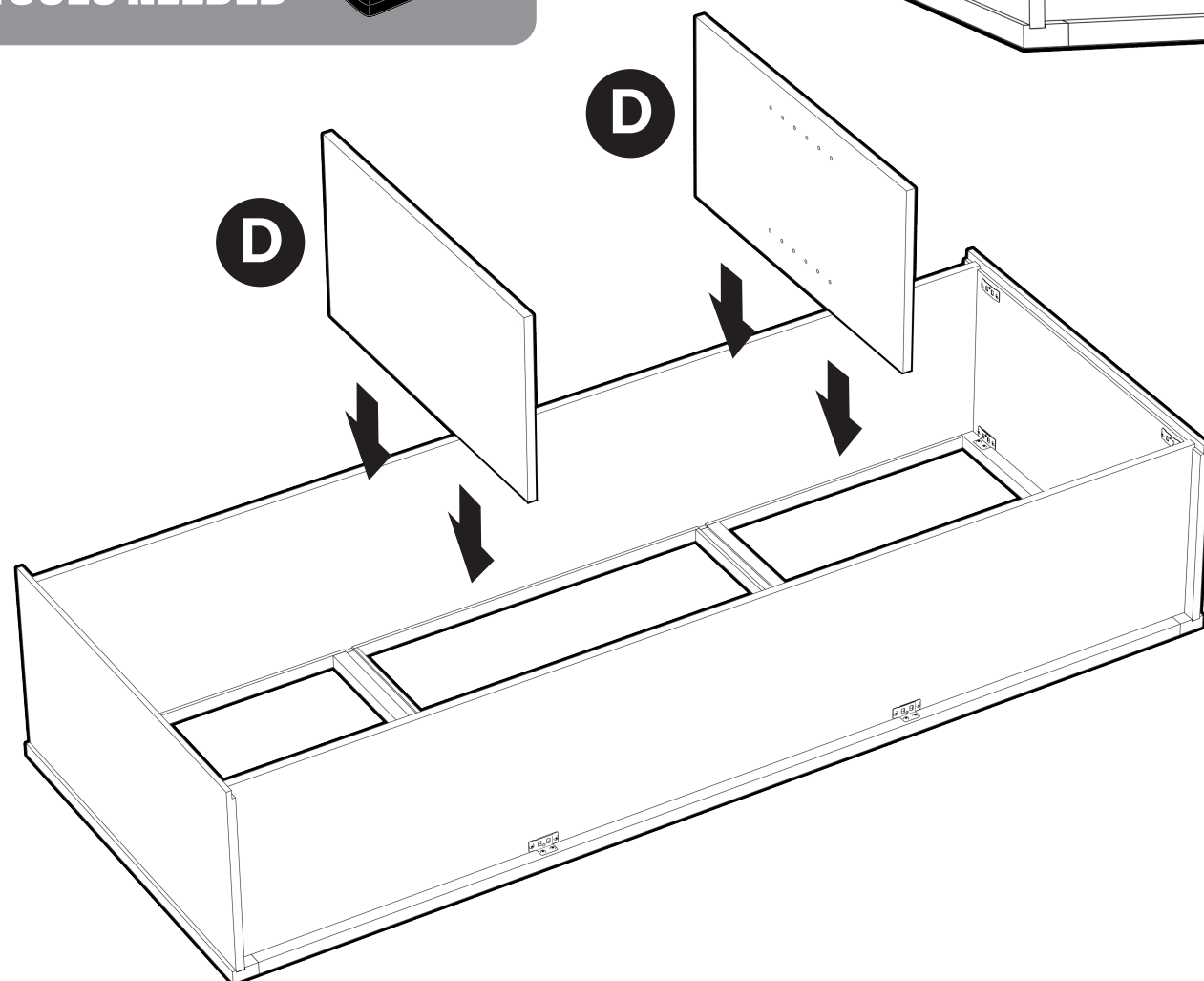
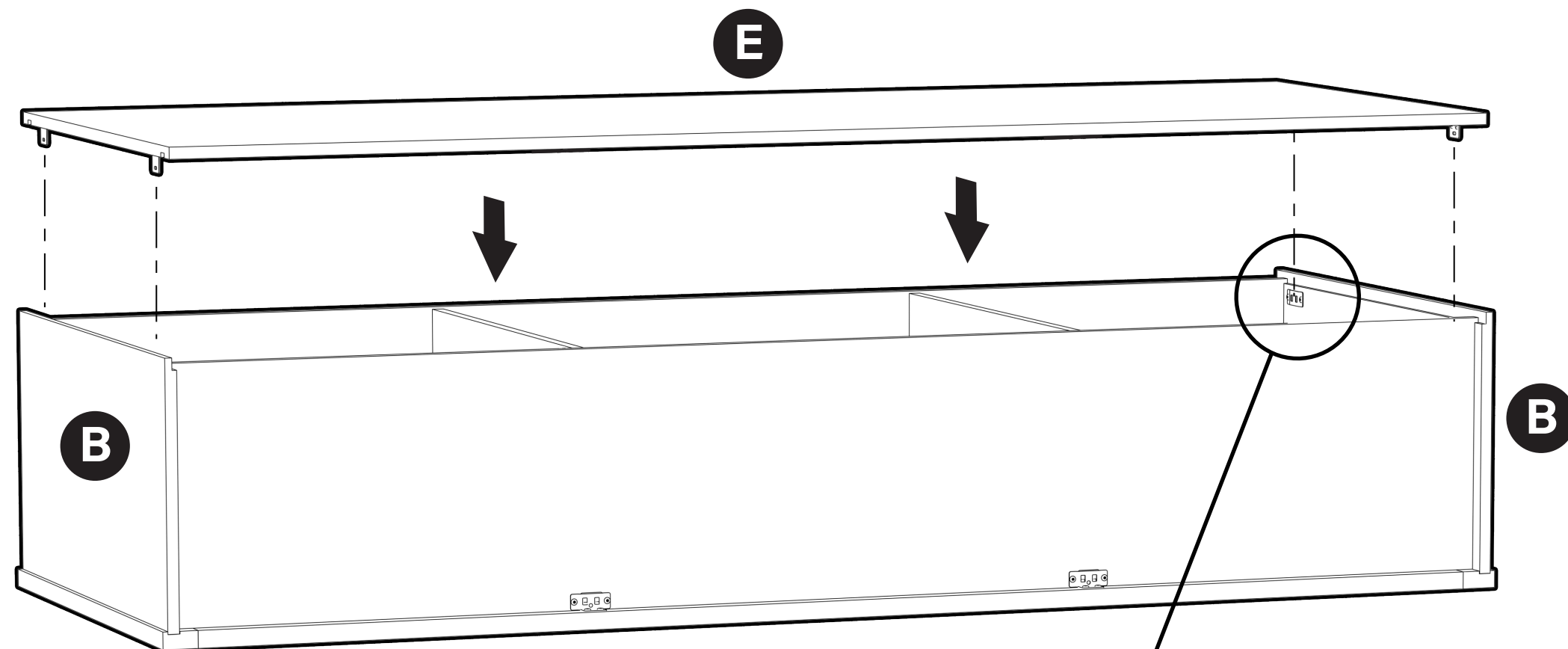
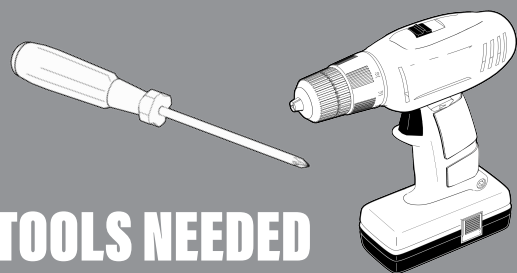

Place (2) Divider Panels (D) into grooves in Face Frame (A) and carefully install Back Panel (E), so that L-Brackets snap into Connector Plates on End Panels (B). Ensure Divider Panels are seated in grooves in Face Frame and Back Panel and tighten Connector Plate screws. Square the cabinet and lock connectors in place with (4) #6 x 1/2" Pan Head screws (M).

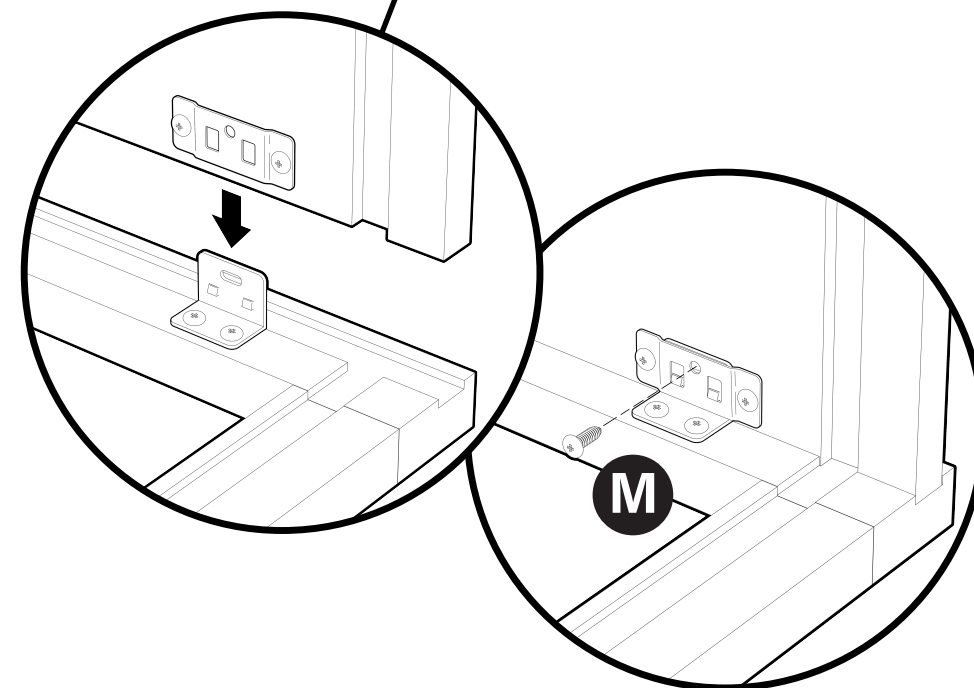

STEP 8

Parts List

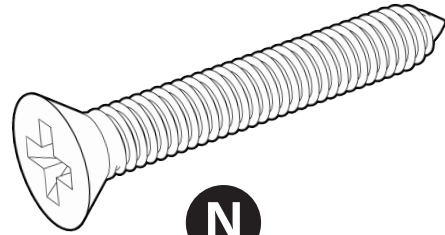

14 - #6 x 1" Flat Head Screws

TOOLS NEEDED

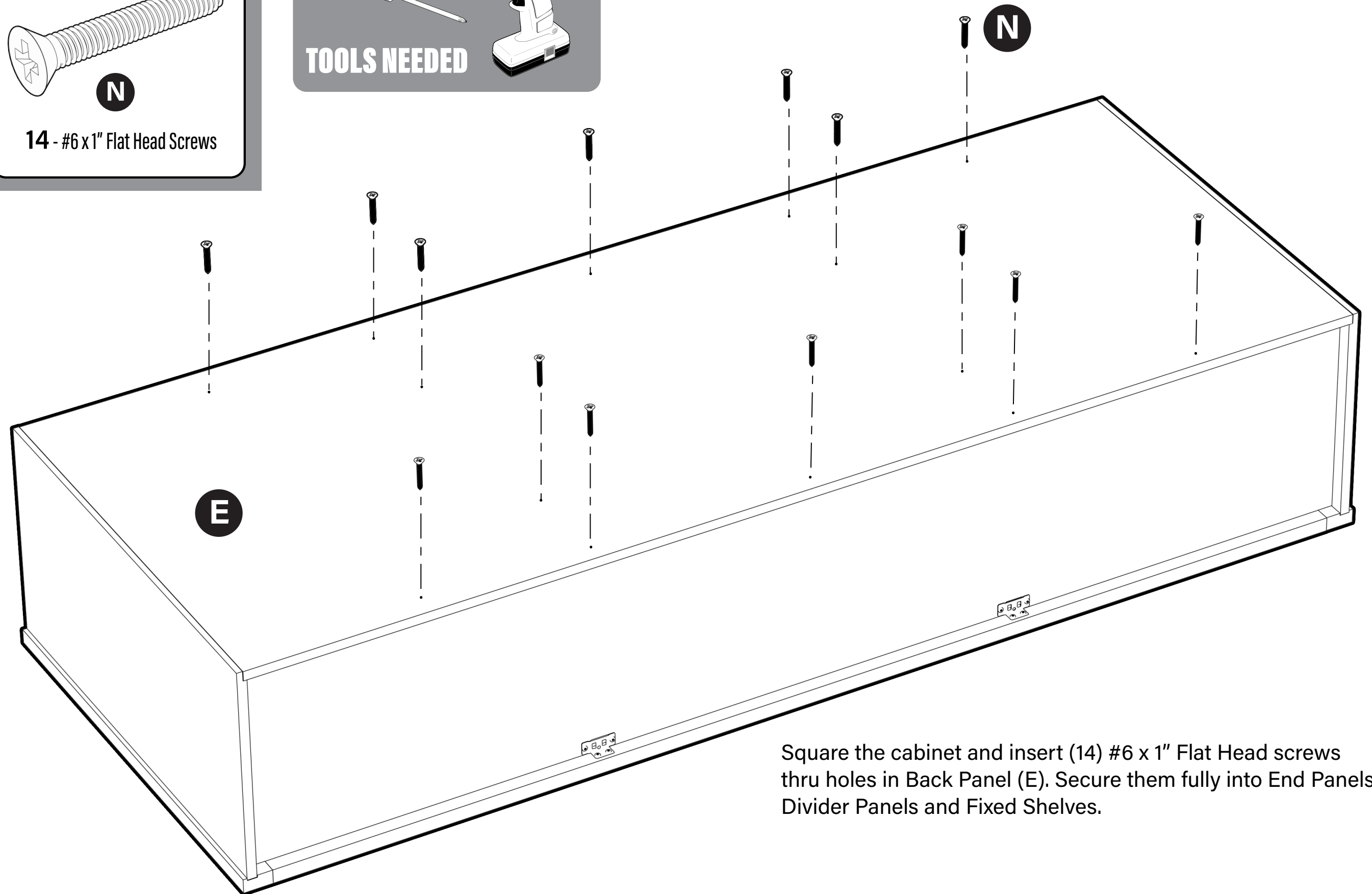
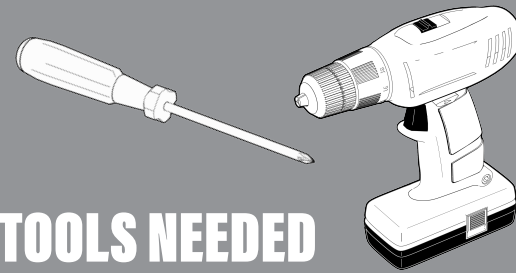

Square the cabinet and insert (14) #6 x 1" Flat Head screws thru holes in Back Panel (E). Secure them fully into End Panels, Divider Panels and Fixed Shelves.

STEP 9

Parts List

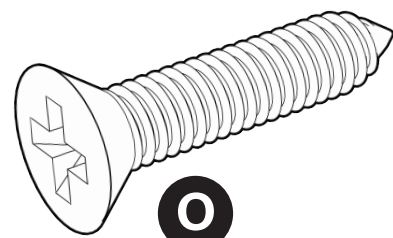

8 - #6 x 5/8" Flat Head Screws

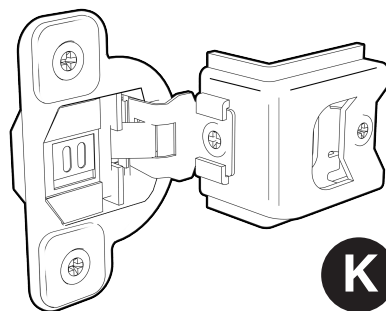

4 - Soft Close Hinges

TOOLS NEEDED

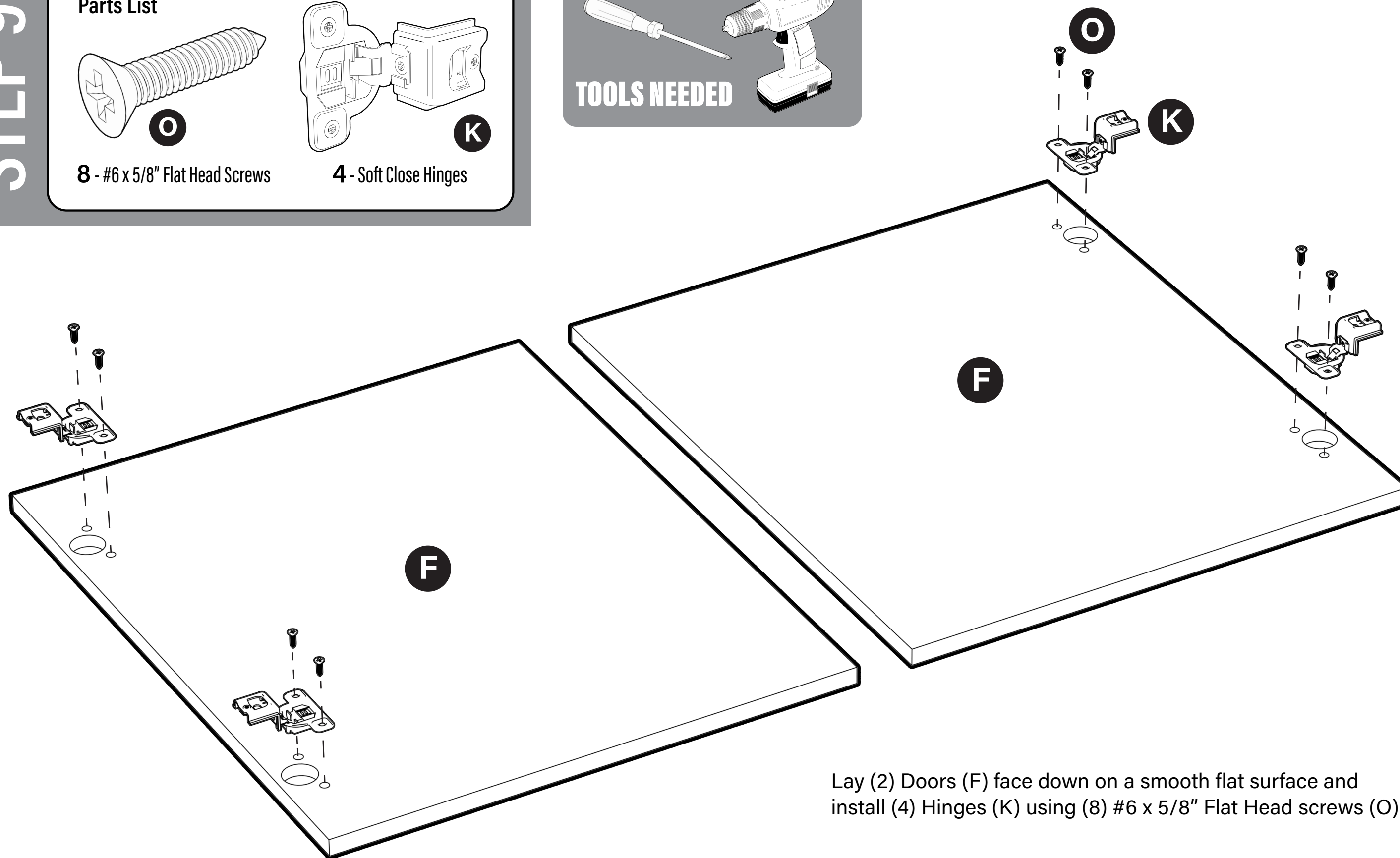
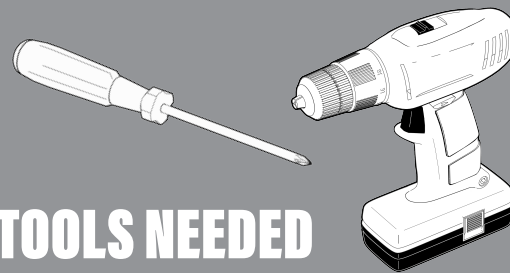

Lay (2) Doors (F) face down on a smooth flat surface and install (4) Hinges (K) using (8) #6 x 5/8" Flat Head screws (O).

STEP 10

Parts List

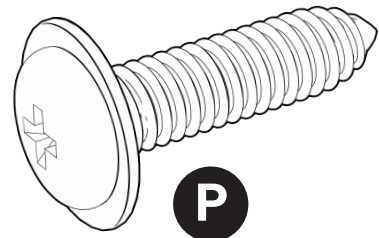

4 - #8 x 7/8" Pan Washer Head Screws

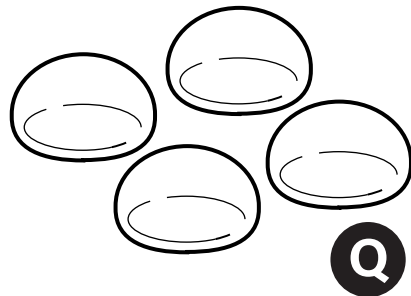

4 - Clear Bumpers

TOOLS NEEDED

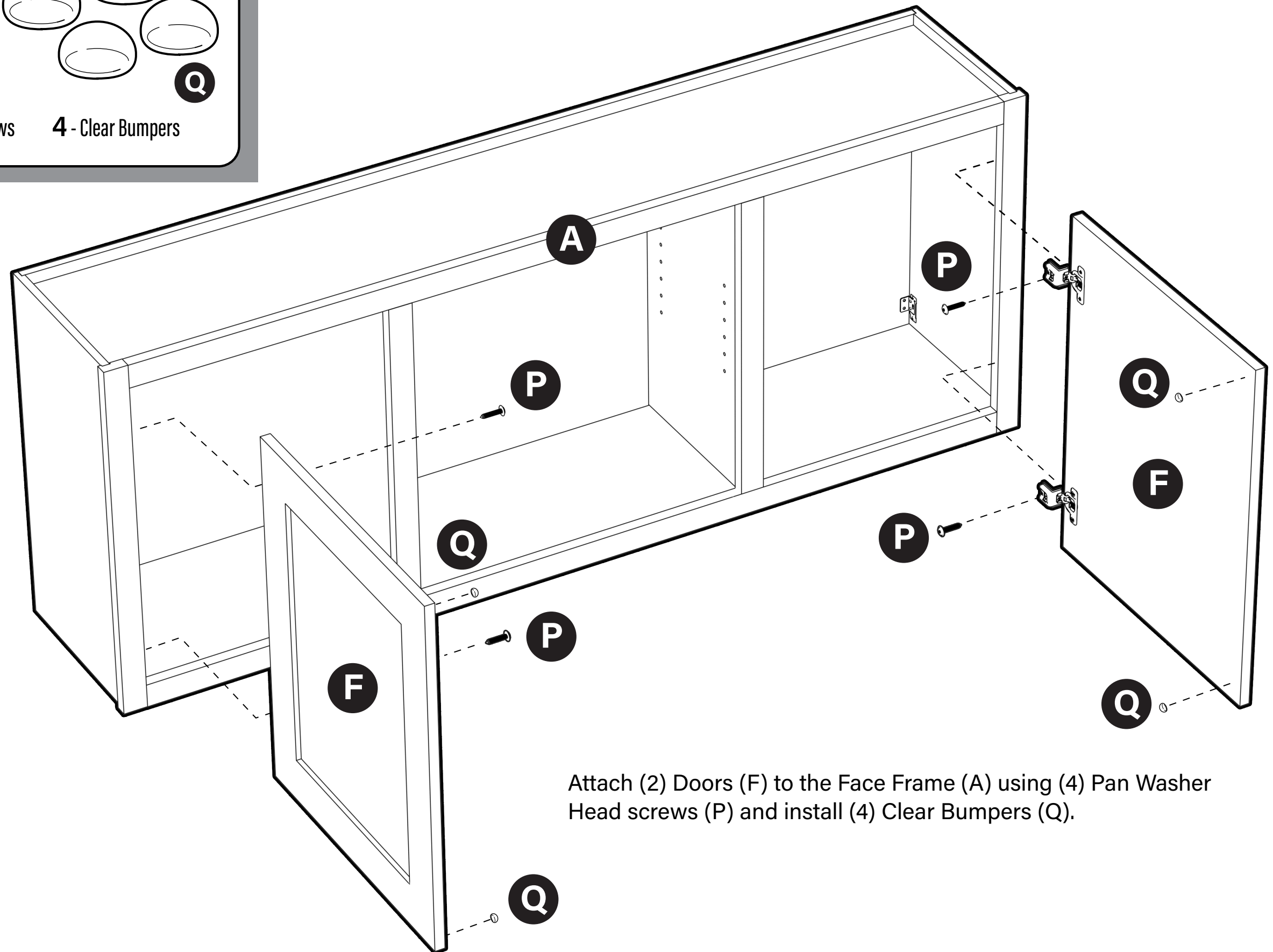
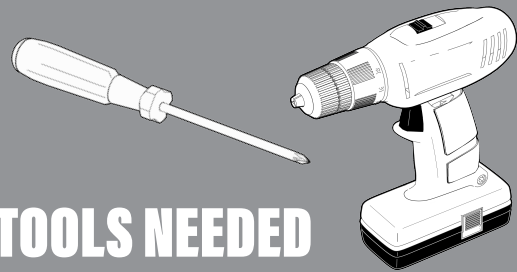

Attach (2) Doors (F) to the Face Frame (A) using (4) Pan Washer Head screws (P) and install (4) Clear Bumpers (Q).

STEP 11

Parts List

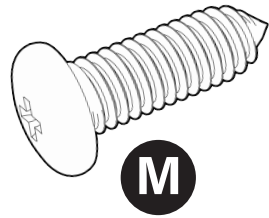

8 - #6 x 1/2" Pan Head Screws

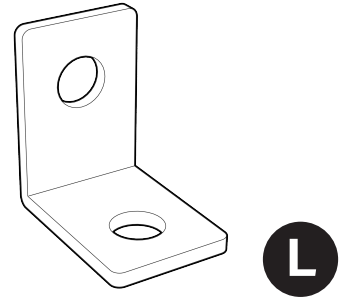

2 - Small L-Brackets

TOOLS NEEDED
Herramientas necesarias

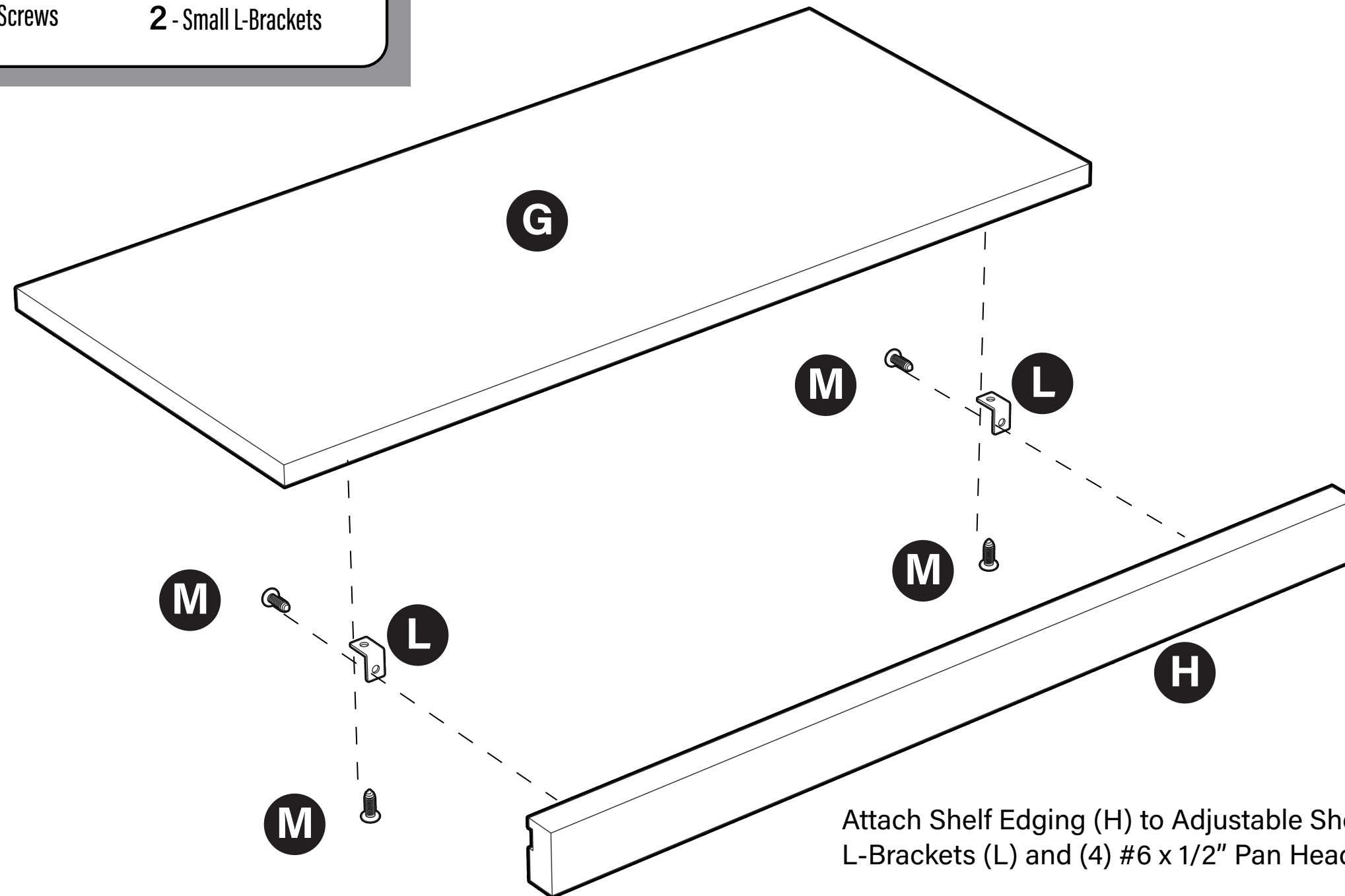

Attach Shelf Edging (H) to Adjustable Shelf (G) using Small L-Brackets (L) and (4) #6 x 1/2" Pan Head screws (M).

STEP 12

Parts List

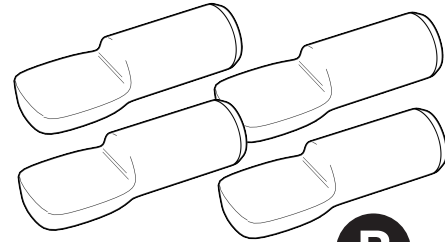

4 - Metal Shelf Rests

R

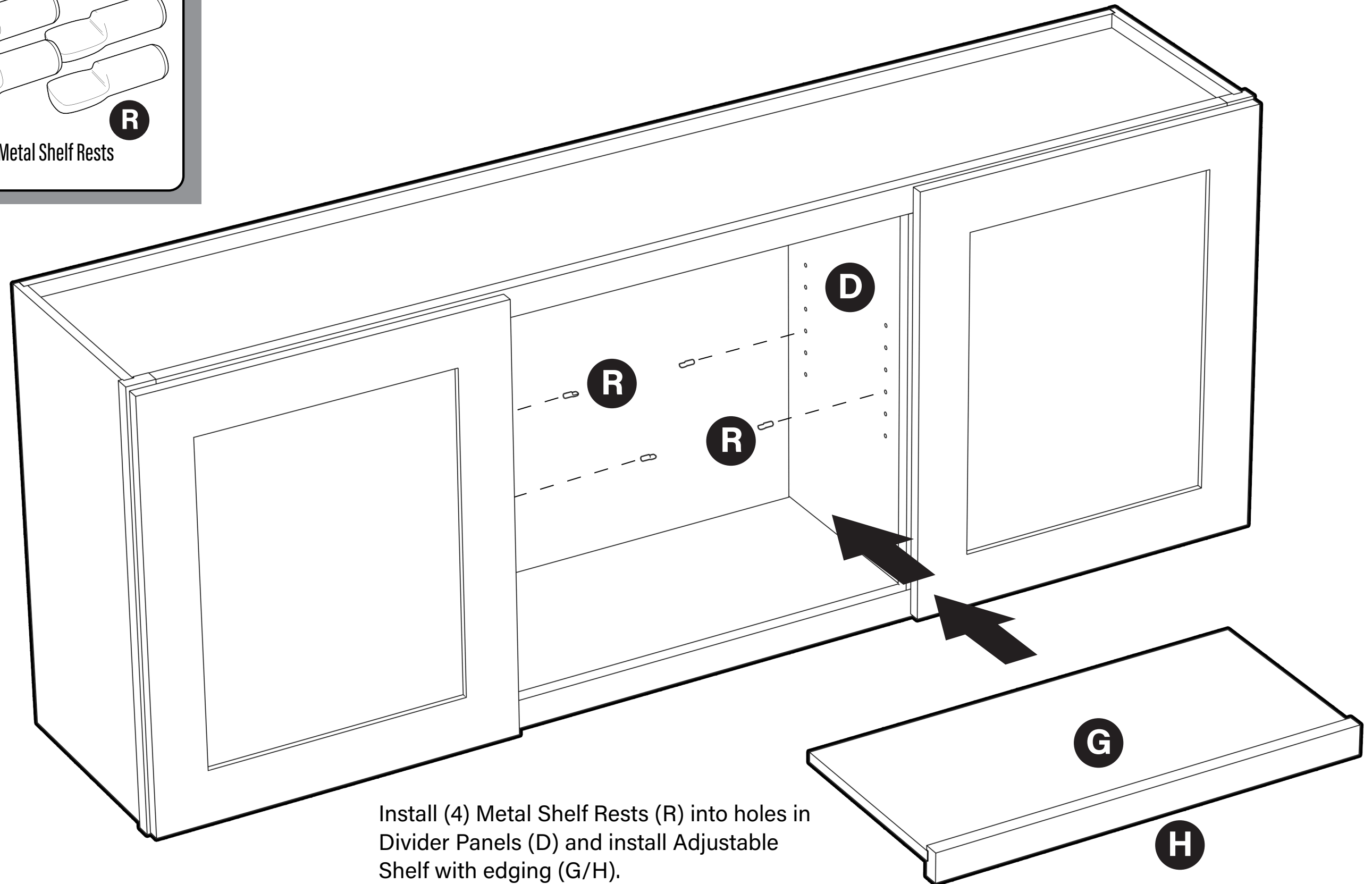

Install (4) Metal Shelf Rests (R) into holes in Divider Panels (D) and install Adjustable Shelf with edging (G/H).

YOU'RE FINISHED



ENJOY!