

Wall Angle Corner Cabinet

ASMBLY-WANGLE

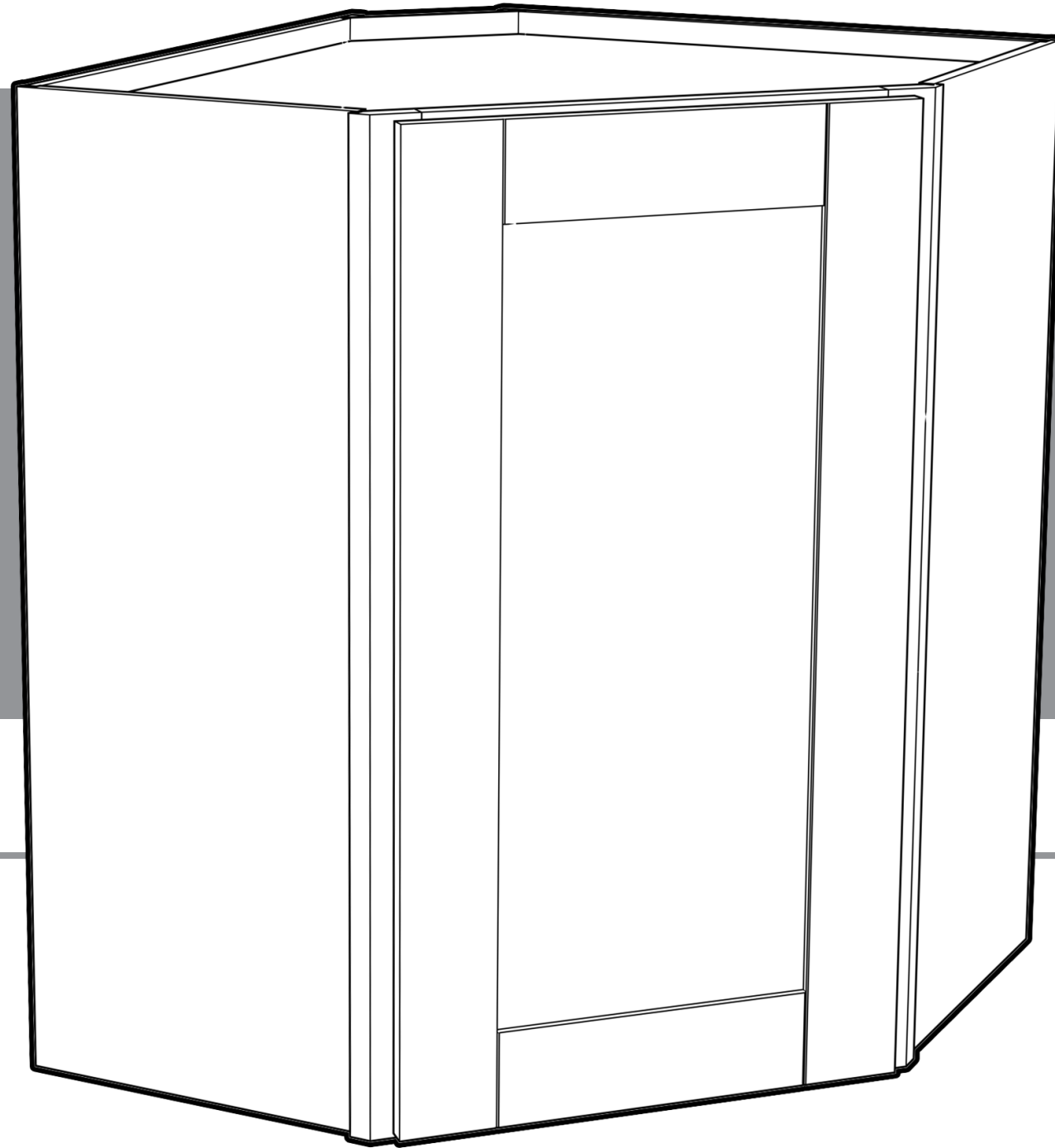

Before you start assembly, inspect all panels and hardware to ensure you have everything needed.

We recommend laying the panels on some cardboard to protect the finish when assembling.

In addition to the tan Connector Brackets supplied, we recommend that you run a bead of white wood glue into each dado groove, as you assemble, to create the strongest cabinet.

REQUIRED TOOLS

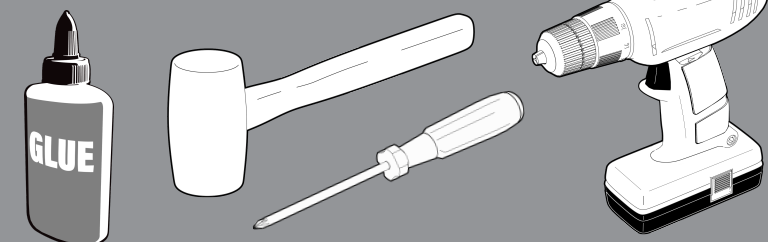

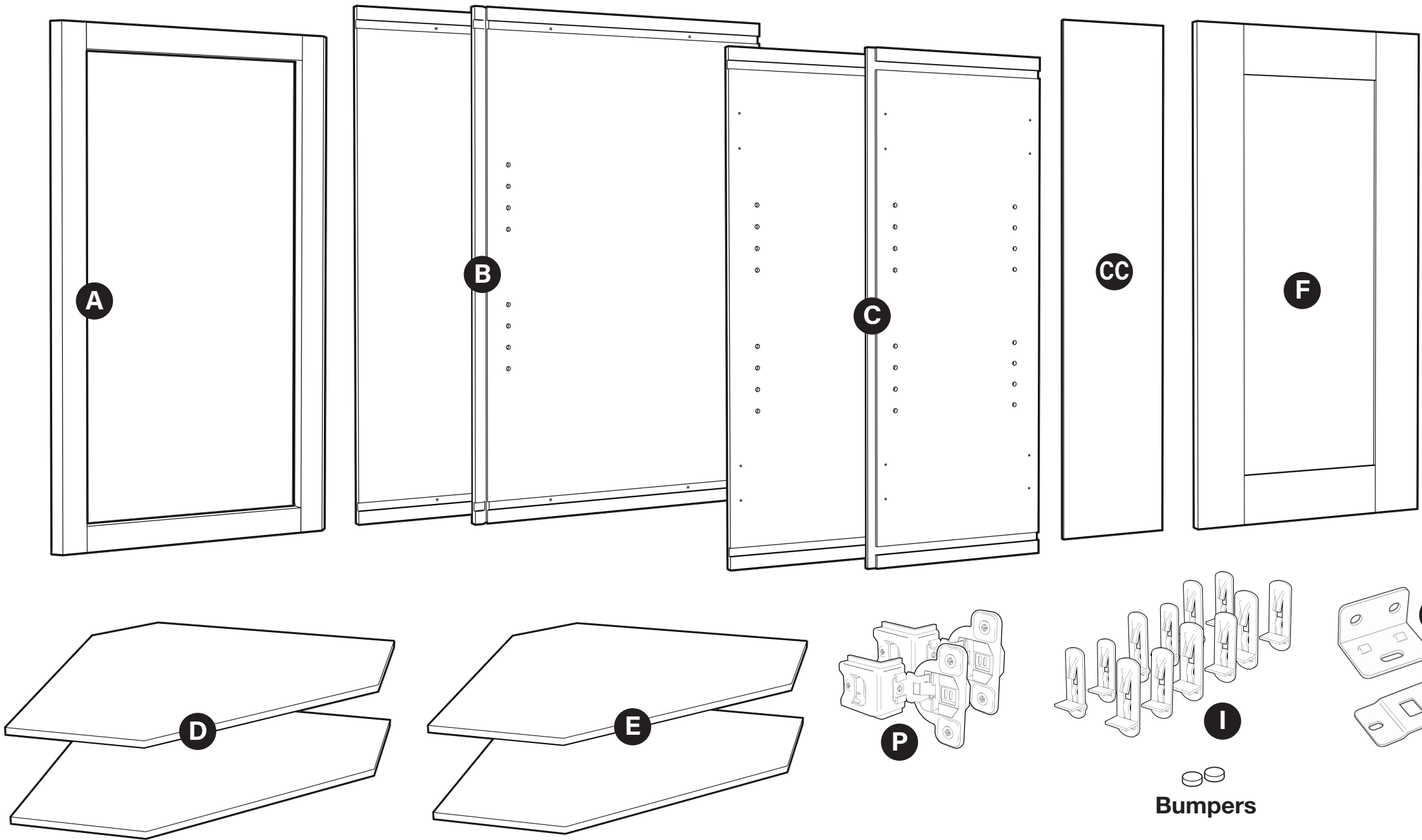

Wall Angle Corner Cabinet



PARTS LIST

- A** 1 x Face Frame
- B** 2 x Back Panel
- C** 2 x End Panels
- CC** 1 x Clipped Corner Panel
- D** 2 x Fixed Shelf
- E** 2 x Adjustable Shelves*
- F** 1 x Door
- G** 8 x Tan RTA L-Brackets
- H** 8 x Tan RTA Connector Plates
- I** 12 x Locking Shelf Rests*
- P** 2 x Door Hinges*

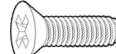
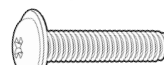
**36" and 42" high wall cabinets will have three adjustable shelves, (12) shelf rests and (3) hinges*

-  40 - #6 x 1/2" Pan Head Screws
-  4 - #6 x 5/8" Flat Countersink Screws
-  2 - #8 x 7/8" Pan Washer Head Screws
-  4 - #6 x 1" Flat Countersink Screws

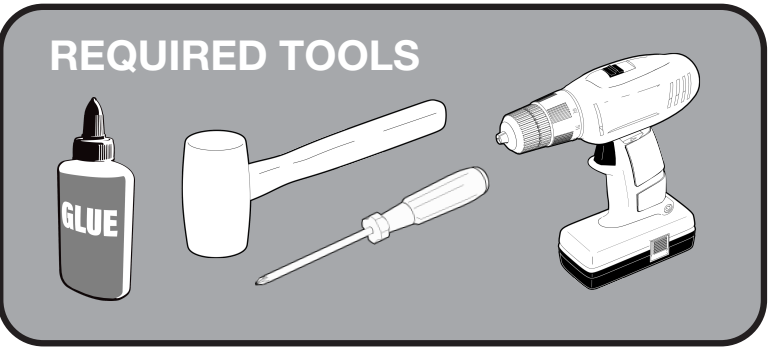

IMPORTANT NOTES:

Before you start assembly, inspect all panels and hardware to ensure you have everything needed. In addition to the tan RTA Connector Brackets supplied, we recommend you run a bead of white wood glue into each groove as you assemble, to create the strongest cabinet. We also recommend laying the panels on some cardboard to protect the finish when assembling.

STEP 1

Parts List

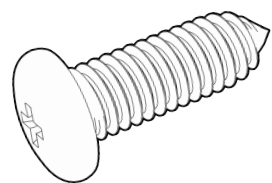

8- #6 x 1/2" Pan Head Screws

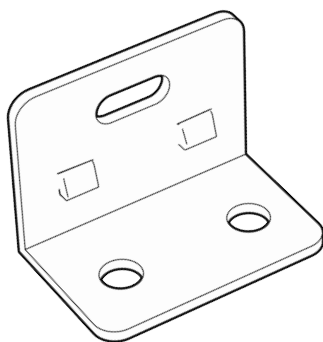

4 - Connector L-Brackets

G

TOOLS NEEDED

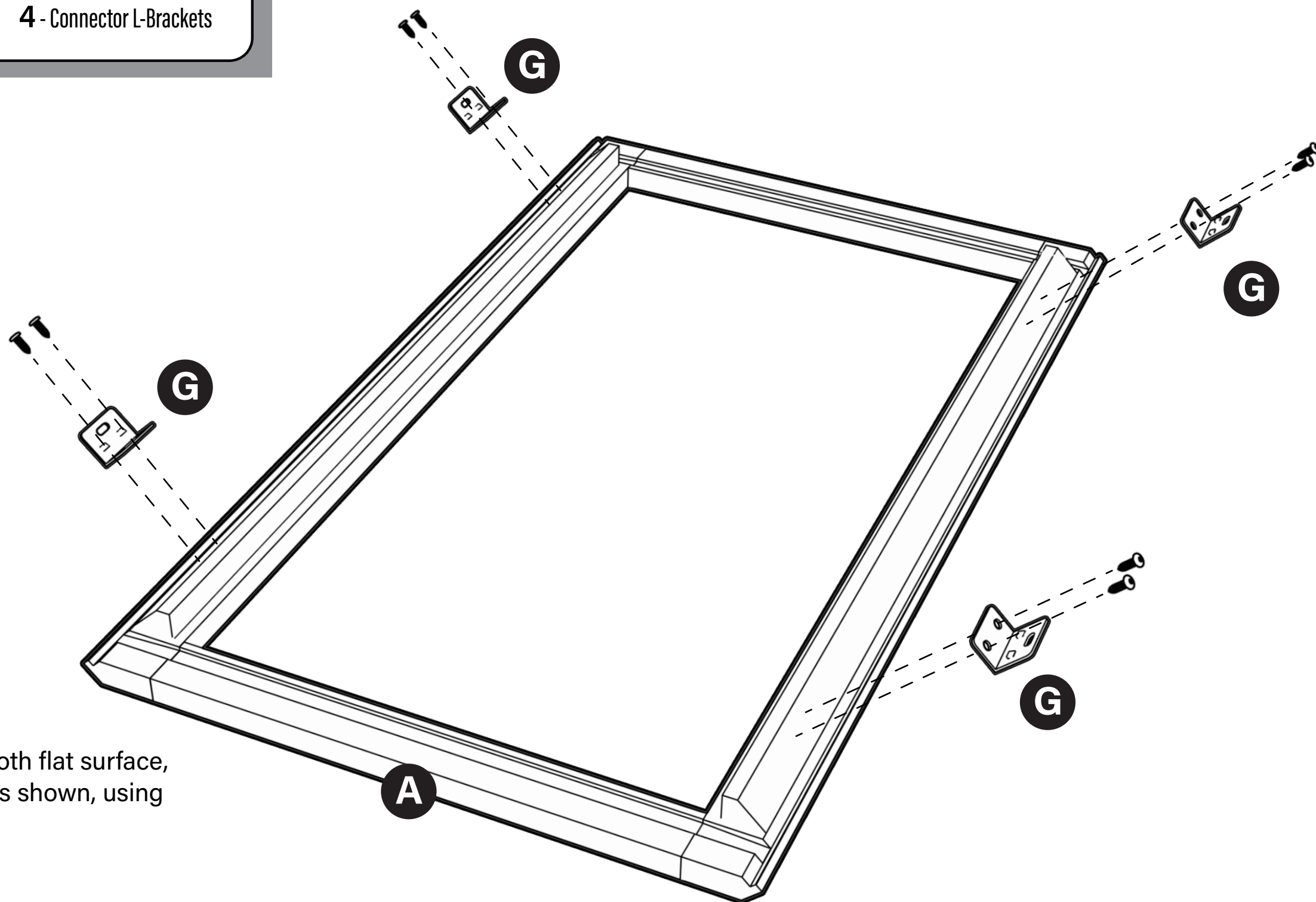
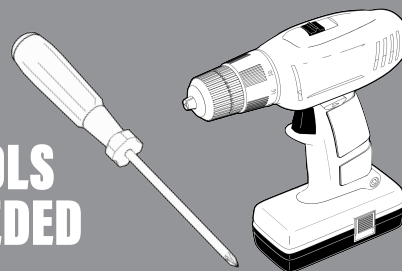

Lay Frame (A) face down on a smooth flat surface, install (4) tan RTA L-Brackets (G), as shown, using (8) #6 x 1/2" Pan Head screws.

STEP 2

Parts List

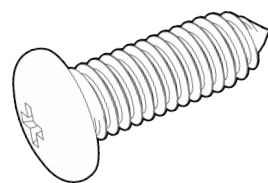

8- #6 x 1/2" Pan Head Screws

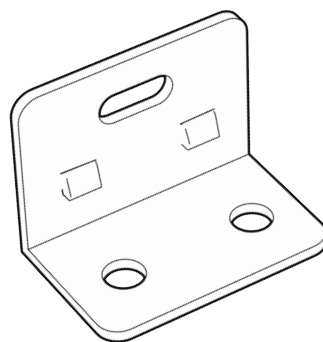

4 - Connector L-Brackets

TOOLS NEEDED

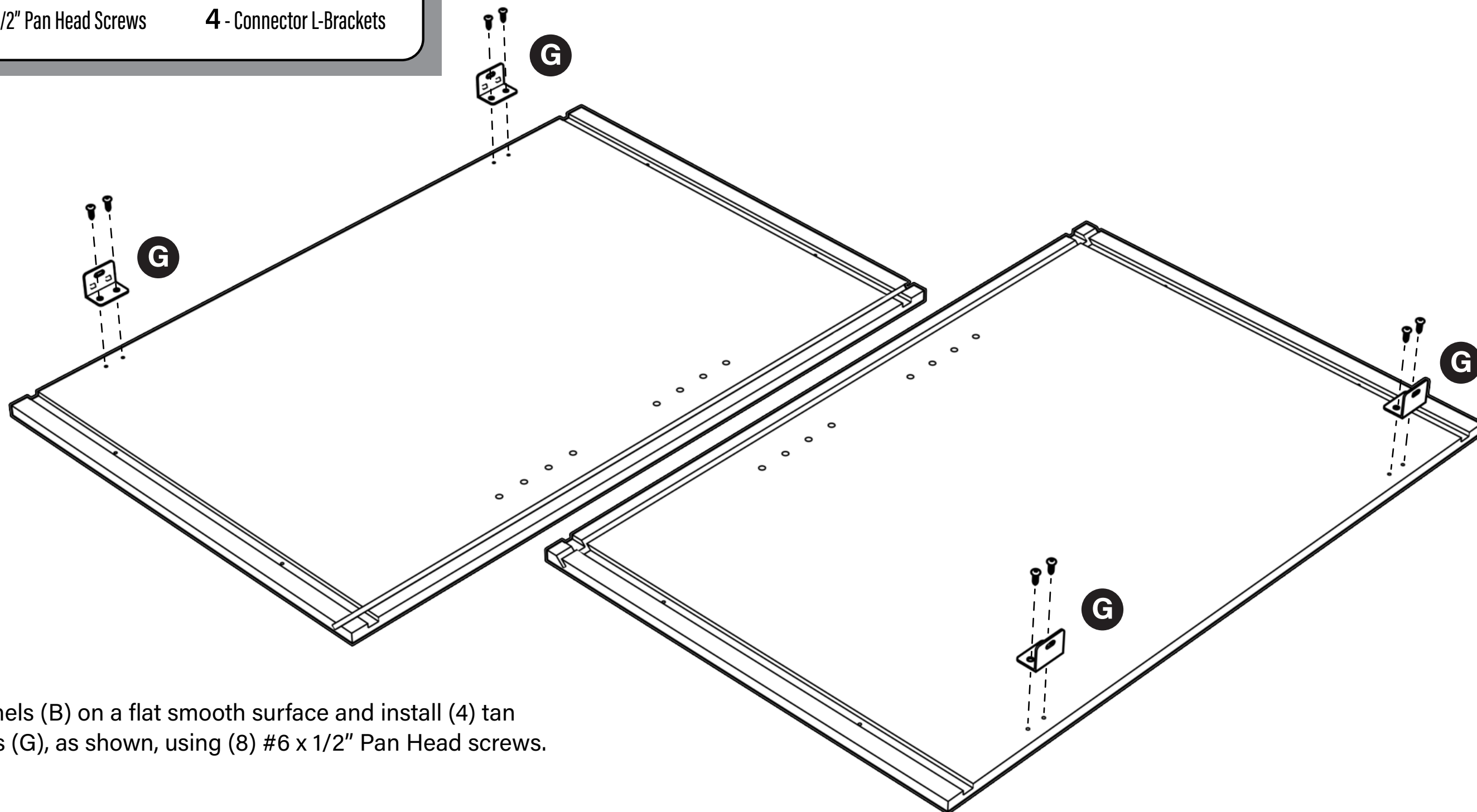
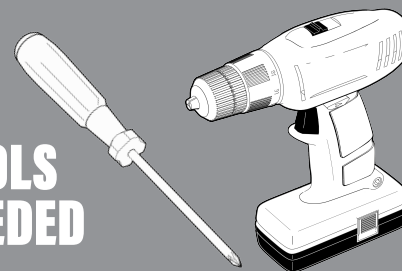

Place Back Panels (B) on a flat smooth surface and install (4) tan RTA L-Brackets (G), as shown, using (8) #6 x 1/2" Pan Head screws.

STEP 3

Parts List

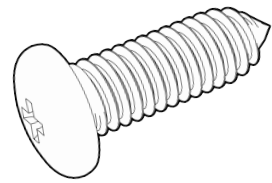

8 - #6 x 1/2" Pan Head Screws

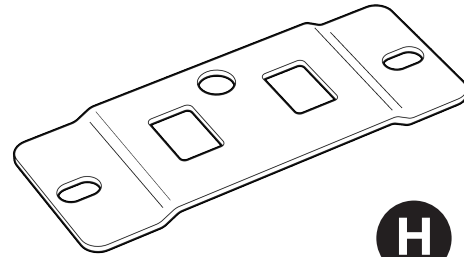

8 - Connector L-Brackets

TOOLS NEEDED

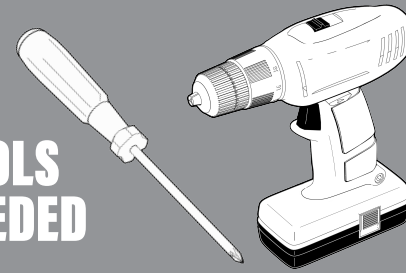

Ensure the central locking hole on the plate is located away from the edge of the panel

Central Locking Hole

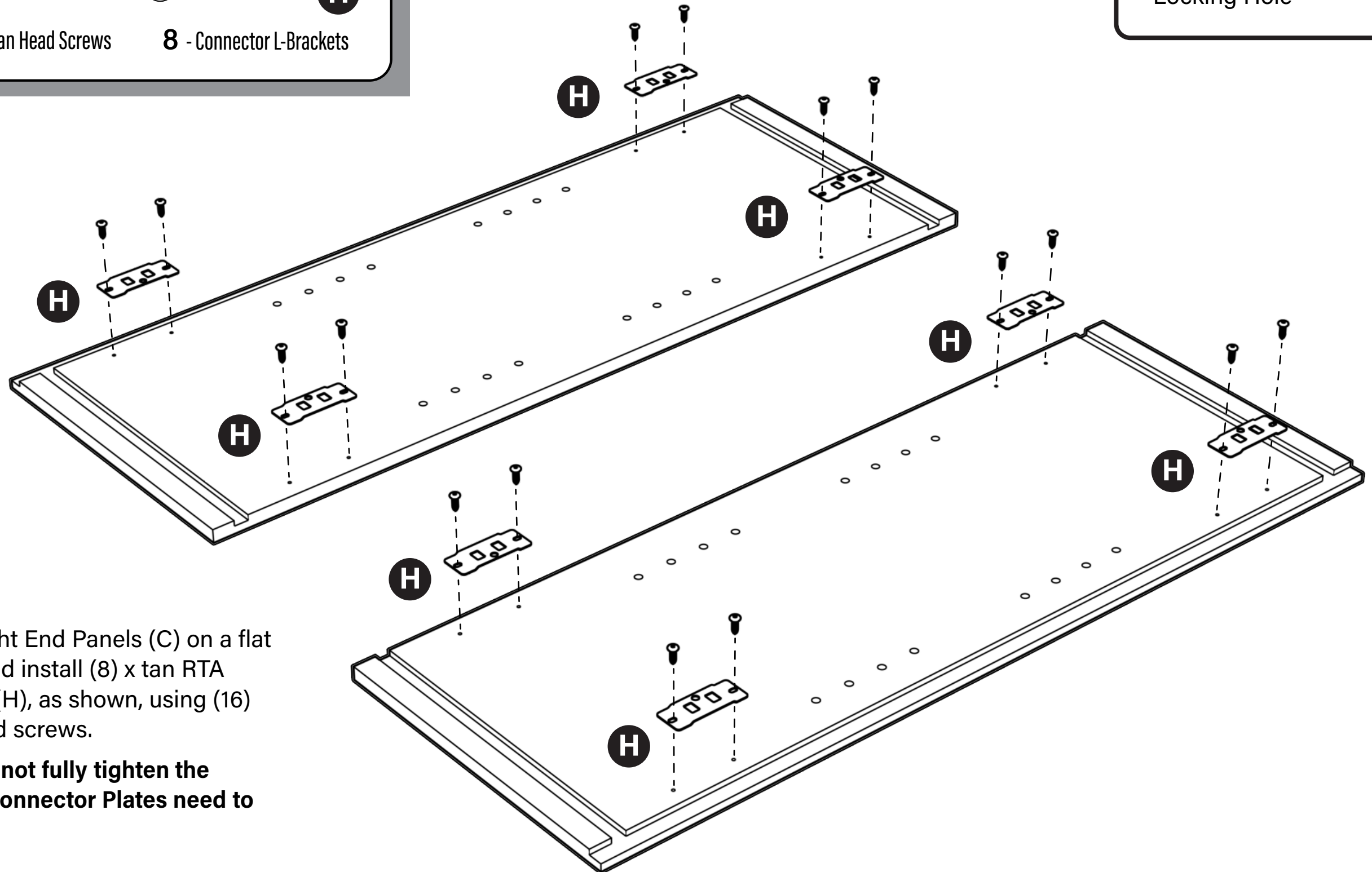

Place Left and Right End Panels (C) on a flat smooth surface and install (8) x tan RTA Connector Plates (H), as shown, using (16) #6 x 1/2" Pan Head screws.

IMPORTANT: Do not fully tighten the screws. The RTA Connector Plates need to be slightly loose

STEP 4

Parts List

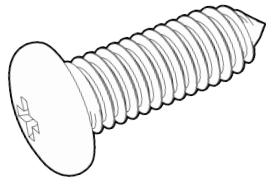

4 - #6 x 1/2" Pan Head Screws

TOOLS NEEDED

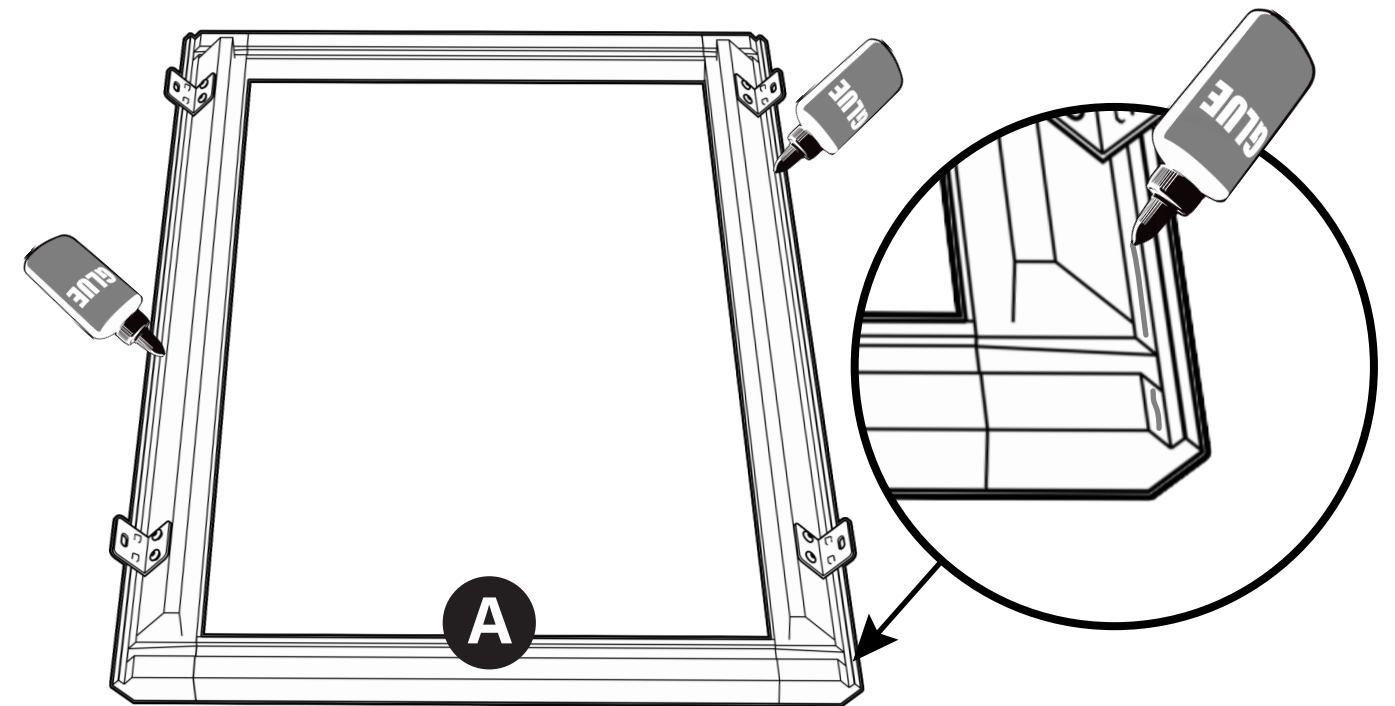
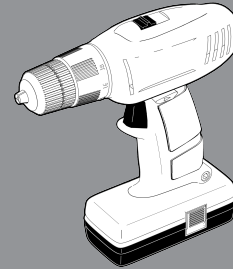
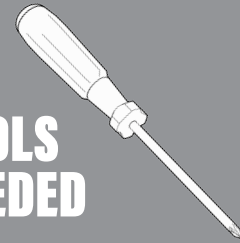

Align the End Panels (C) with the Frame (A), so that the dado grooves line up. Now, fully tighten all the Connector Plate screws and secure the Connector Plates and L-Brackets with (4) #6 x 1/2" Pan Head locking screws.

Run a bead of wood glue in vertical recesses in the Frame (A) and insert End Panels (C), so that L-Brackets (G) & Connector Plates (H) snap together.

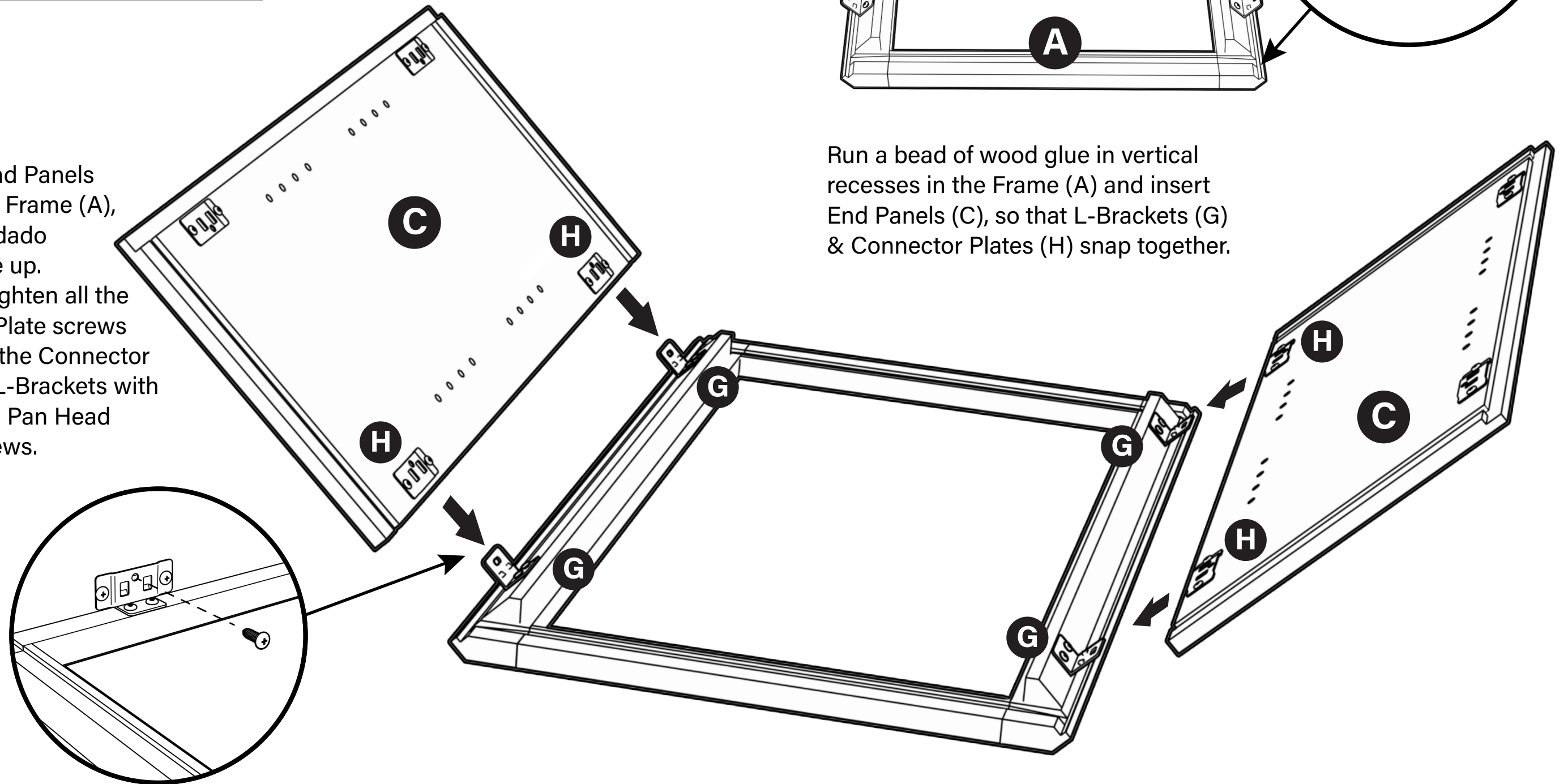

STEP 5



TOOLS NEEDED

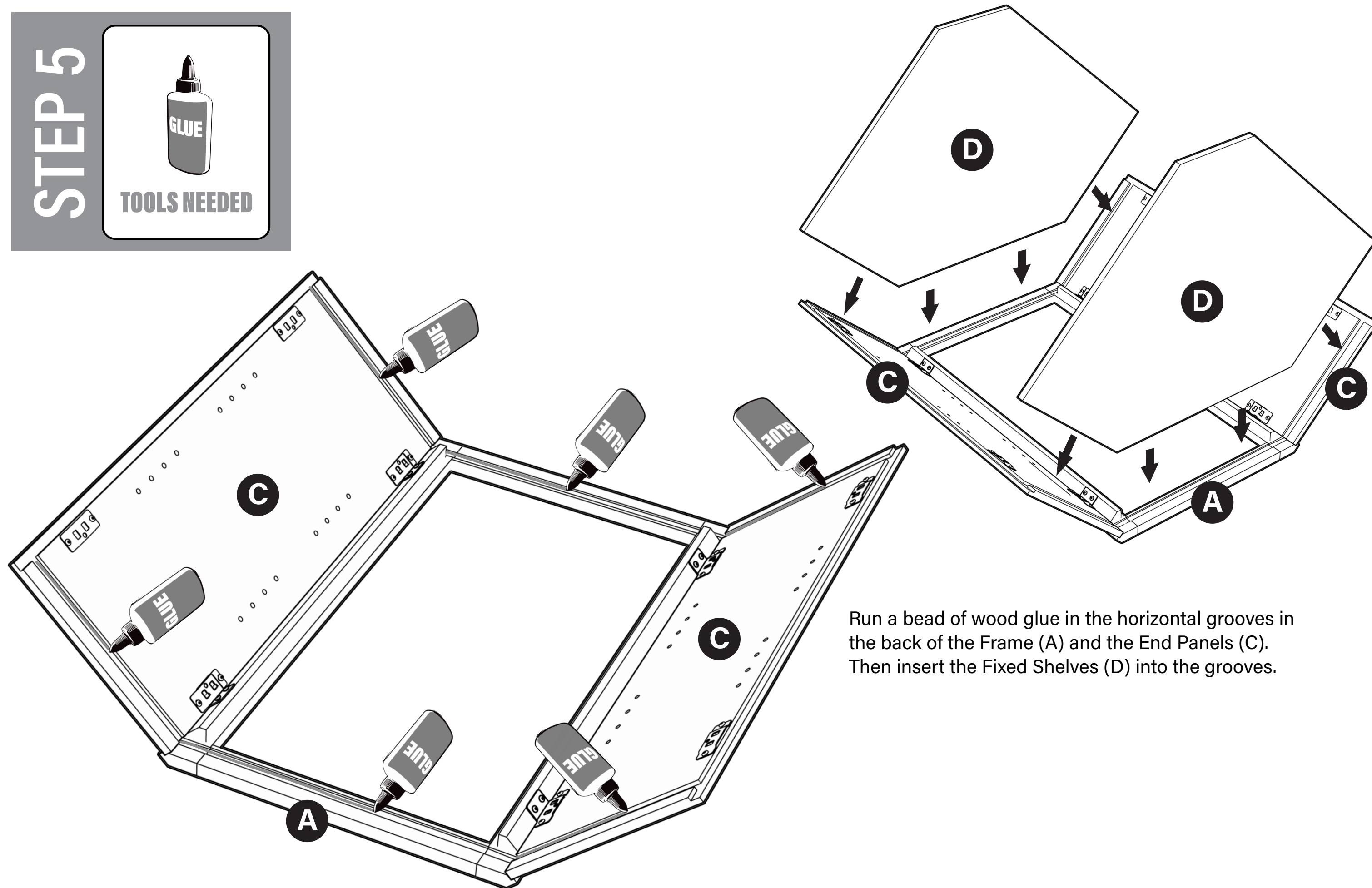

Run a bead of wood glue in the horizontal grooves in the back of the Frame (A) and the End Panels (C). Then insert the Fixed Shelves (D) into the grooves.

STEP 6



TOOLS NEEDED

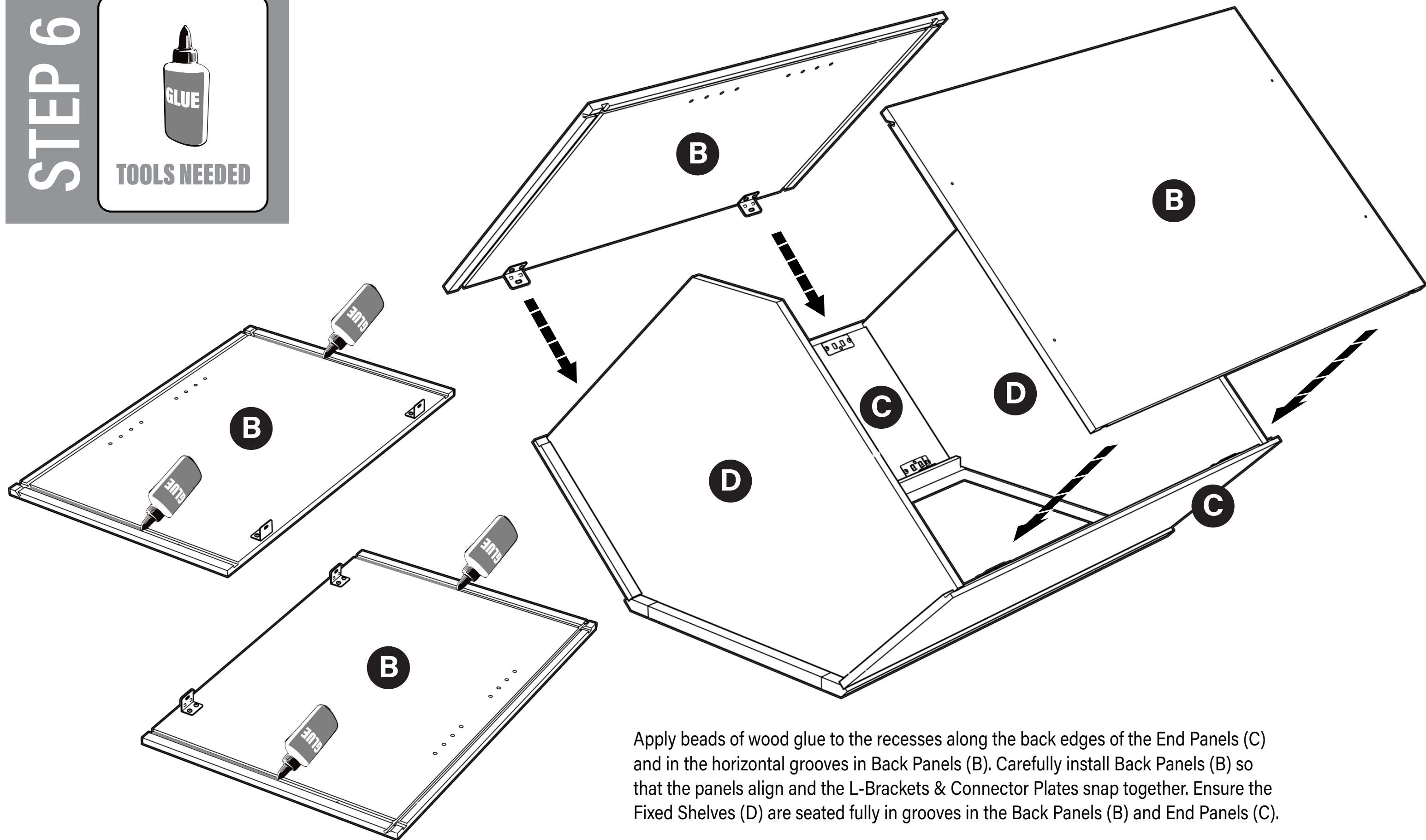

Apply beads of wood glue to the recesses along the back edges of the End Panels (C) and in the horizontal grooves in Back Panels (B). Carefully install Back Panels (B) so that the panels align and the L-Brackets & Connector Plates snap together. Ensure the Fixed Shelves (D) are seated fully in grooves in the Back Panels (B) and End Panels (C).

STEP 7

Parts List

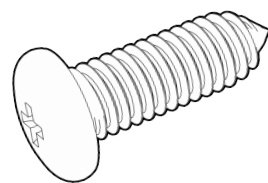

4- #8 x 1/2" Pan Head Screws

TOOLS NEEDED

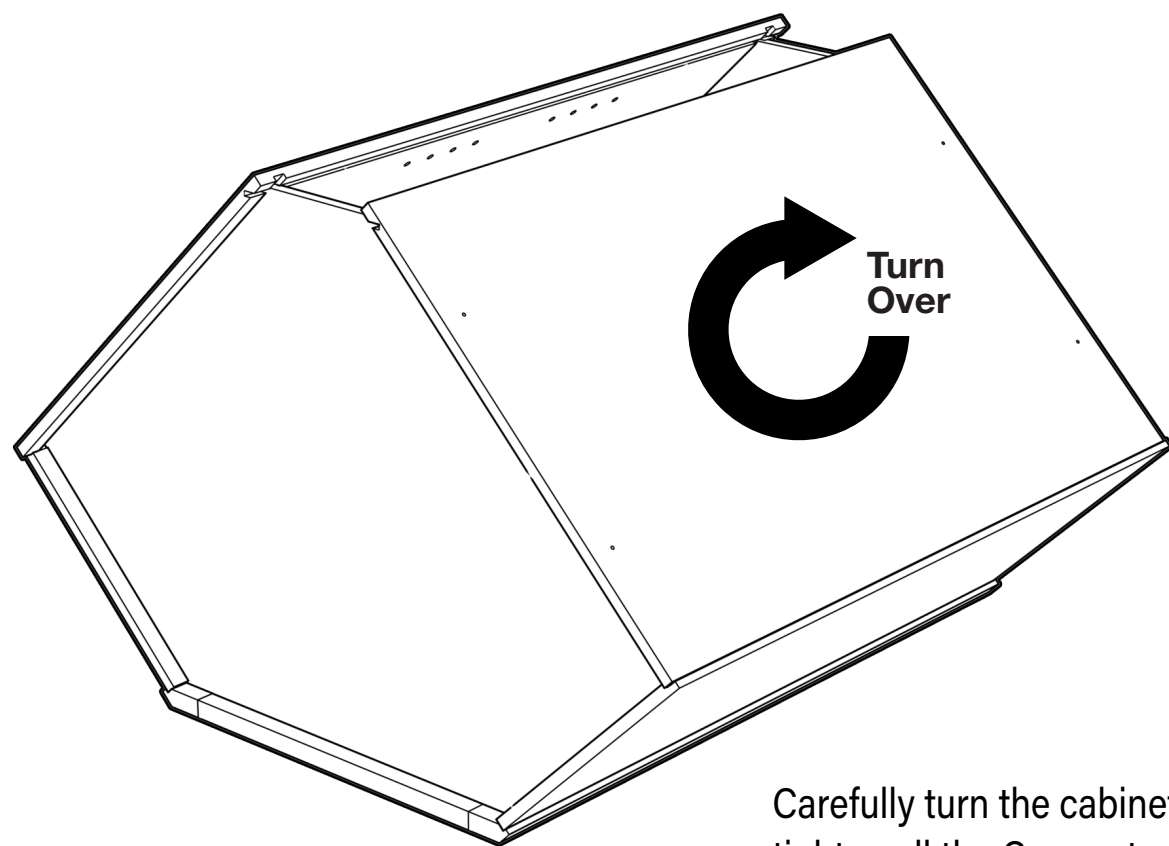
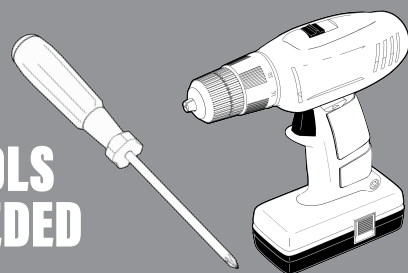

Carefully turn the cabinet over, make sure it is square. Now fully tighten all the Connector Plate screws and secure the Connector Plates and L-Brackets with (4) #6 x 1/2" Pan Head locking screws.

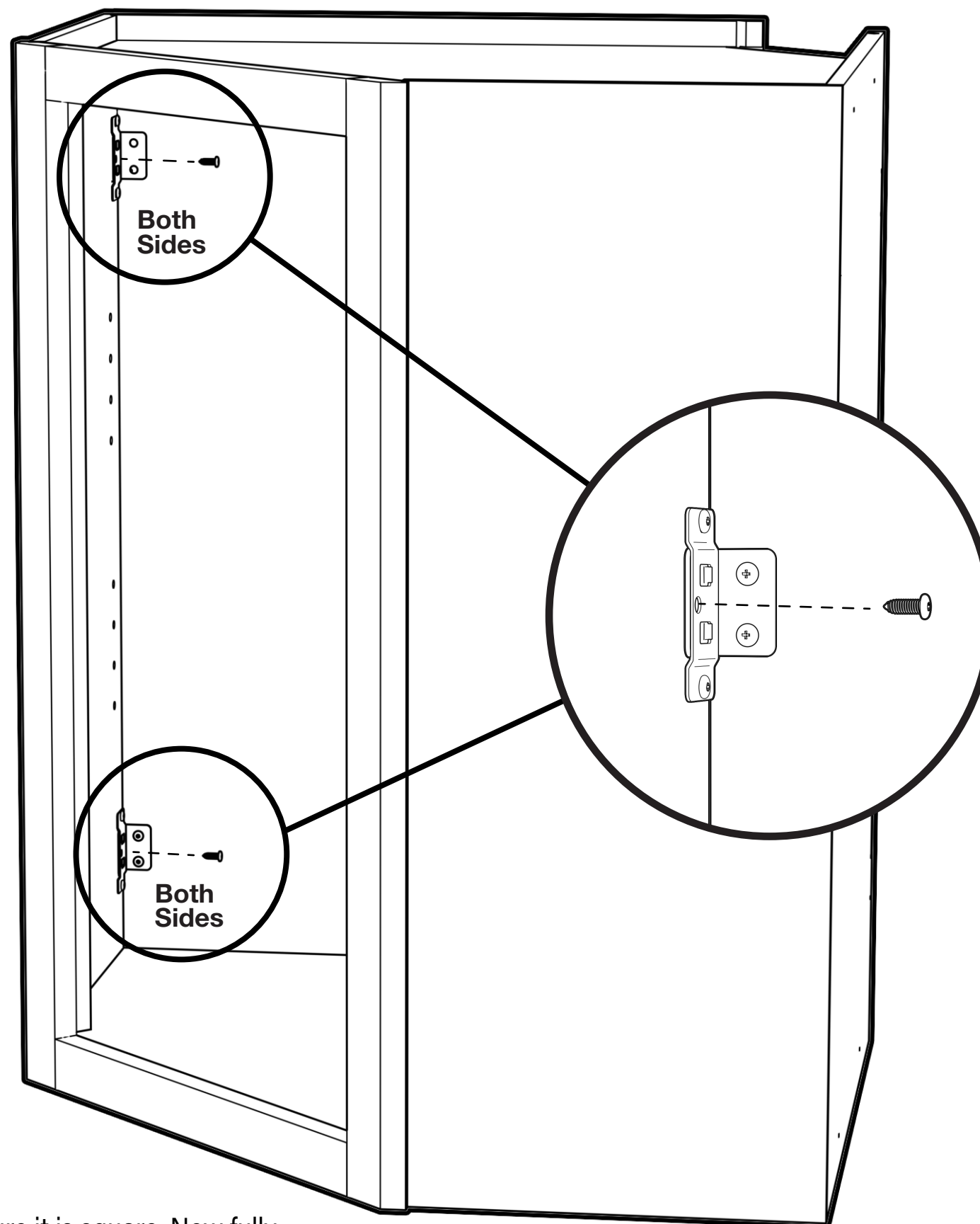

STEP 8

Parts List

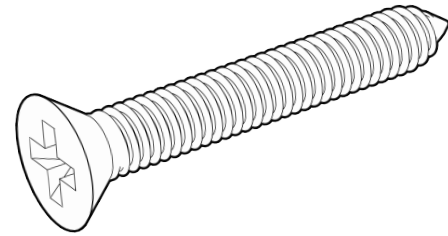

8- #6 x 1" Flat Head Screws

TOOLS NEEDED

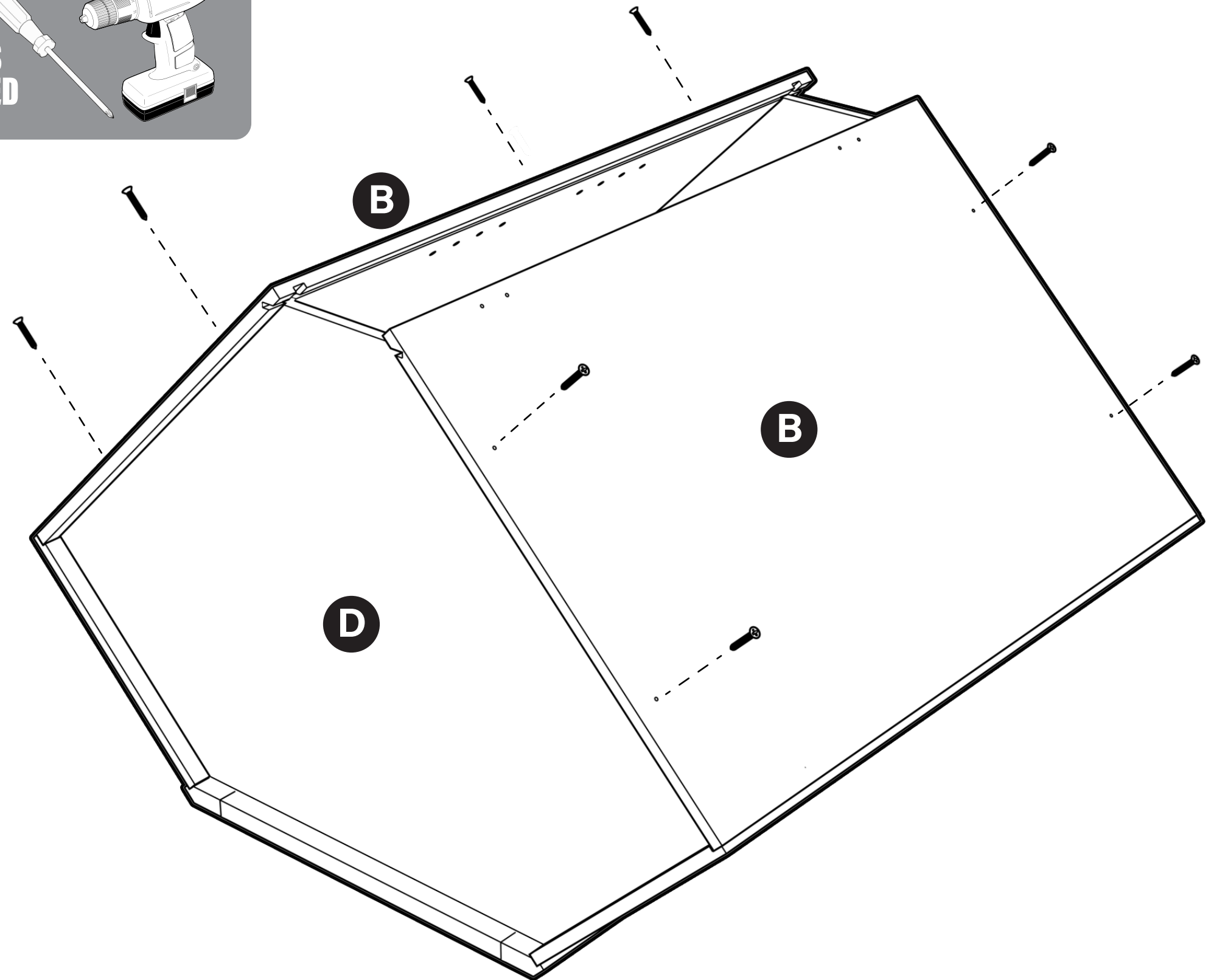
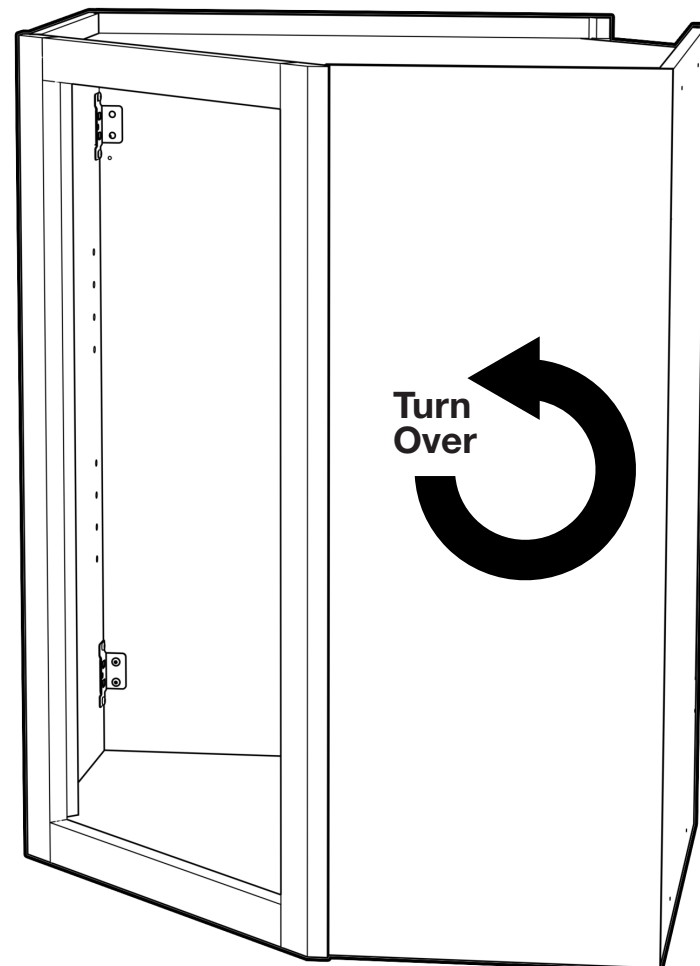
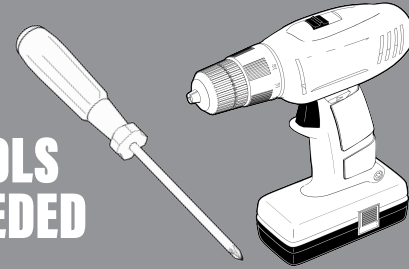

Turn the cabinet over again, check it is square and insert (8) #6 x 1" Flat Head screws, thru holes in Back Panels (B). Tighten securely into Fixed Shelves (D).

STEP 9

Parts List

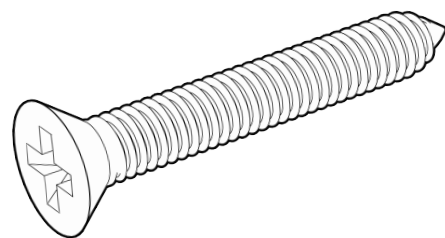

2- #6 x 1" Flat Head Screws

TOOLS NEEDED

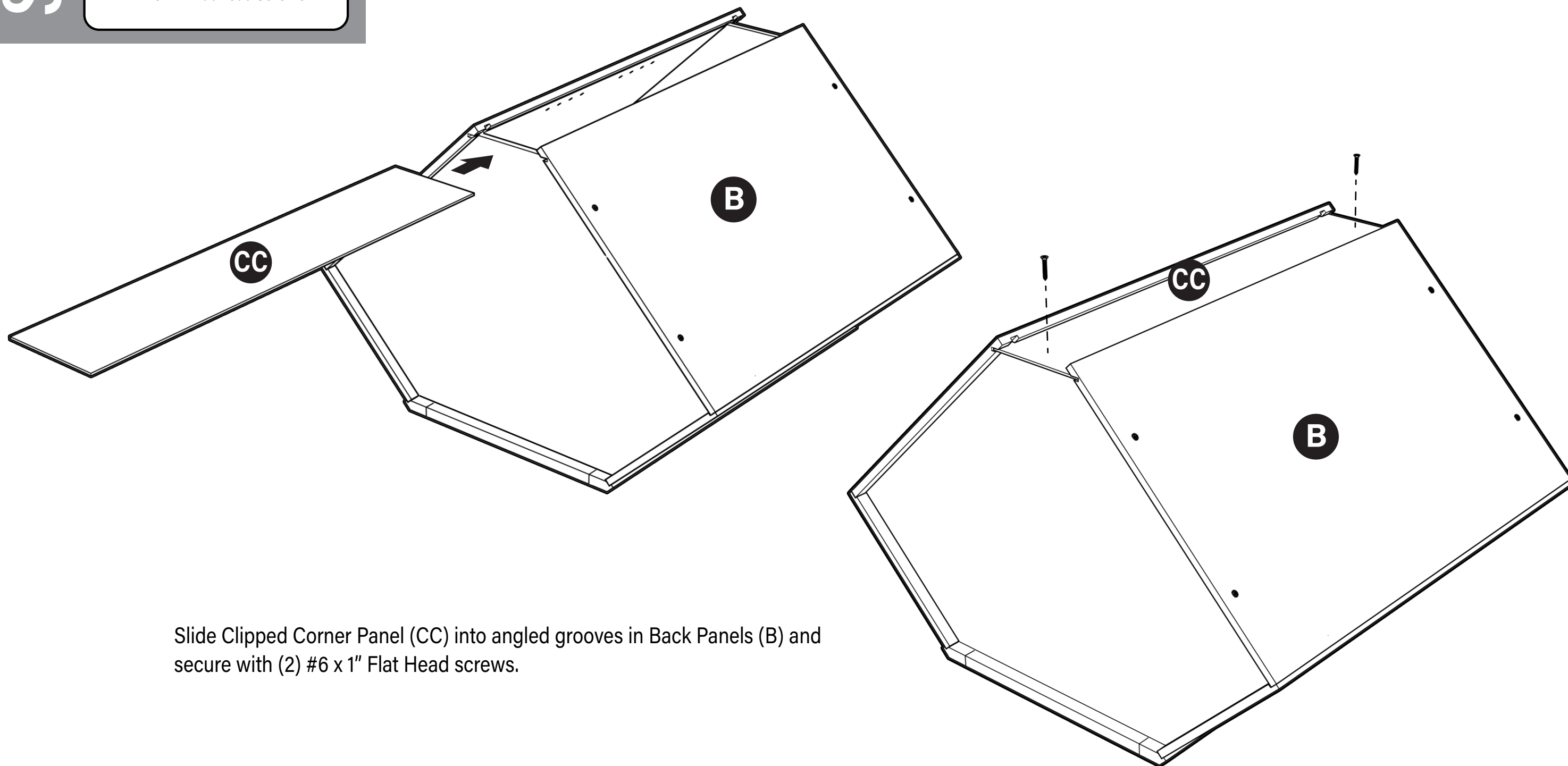
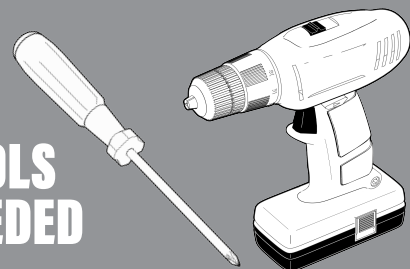

Slide Clipped Corner Panel (CC) into angled grooves in Back Panels (B) and secure with (2) #6 x 1" Flat Head screws.

STEP 10

Parts List

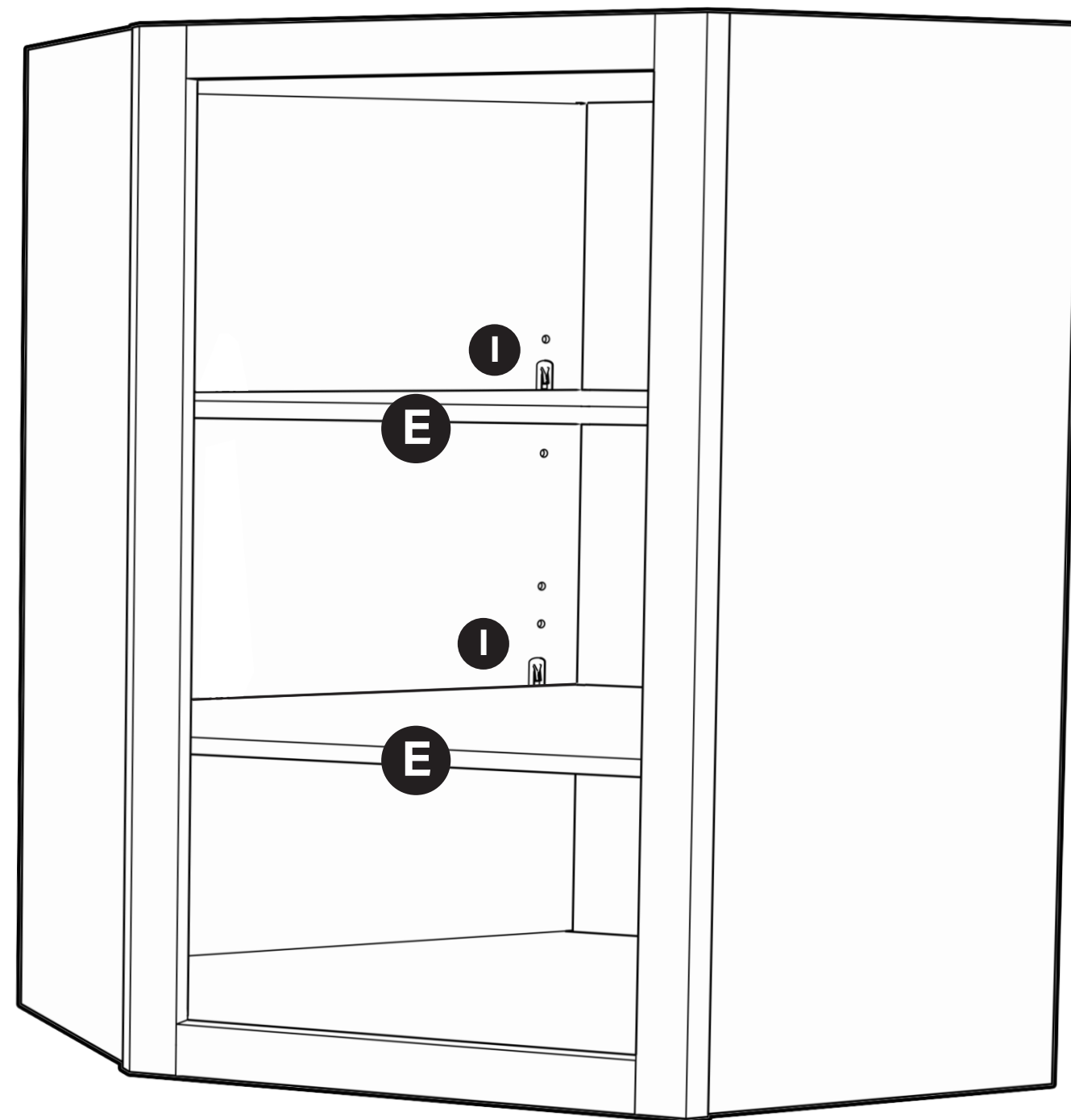
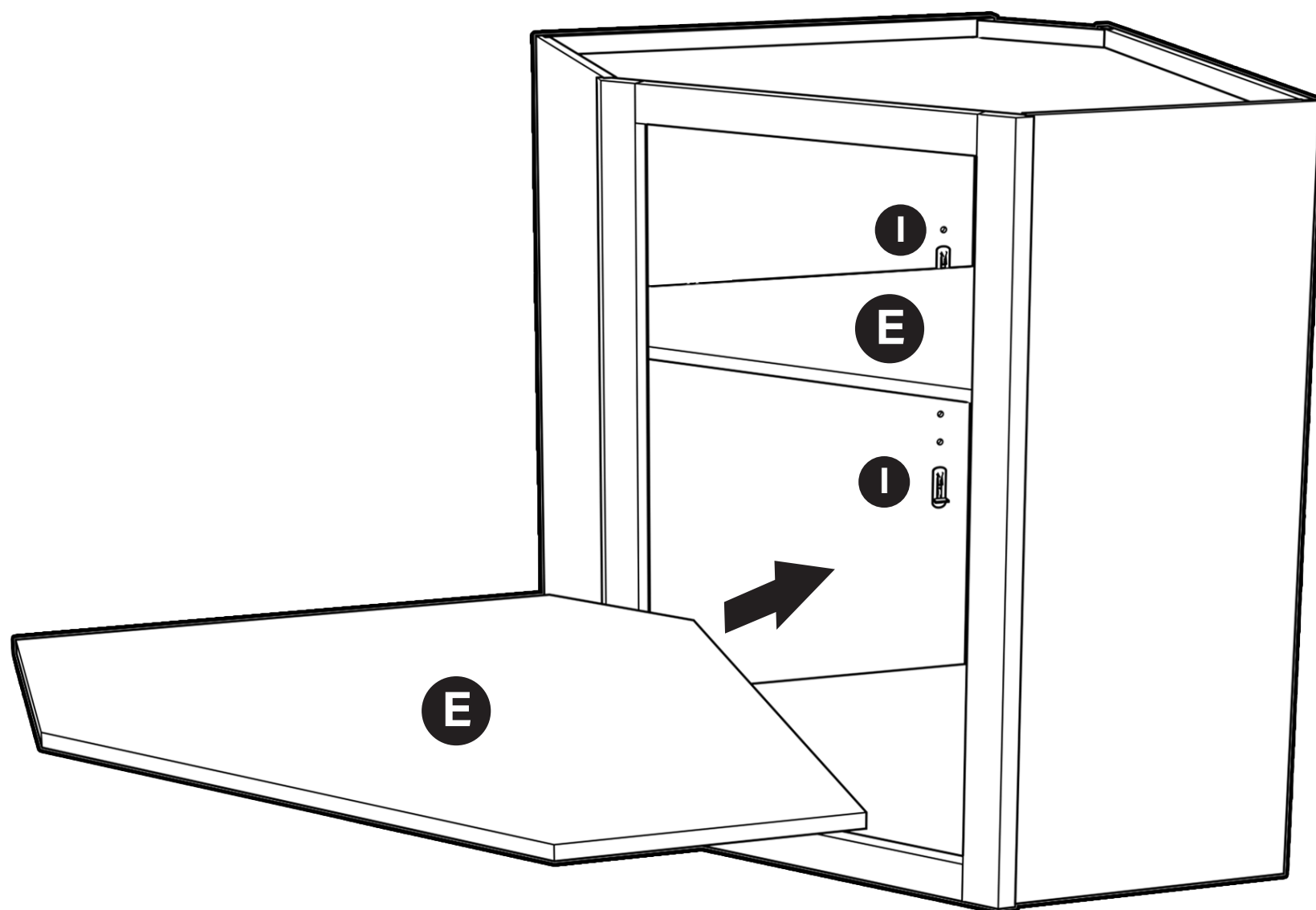

Insert (12) Locking Shelf Rests (I) in desired locations and install Adjustable Shelves (E).

**36" and 42" high cabinet will have three Adjustable Shelves*

STEP 11

Parts List

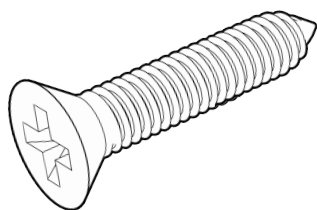

4- #6 x 5/8" Flat Head screws

TOOLS NEEDED

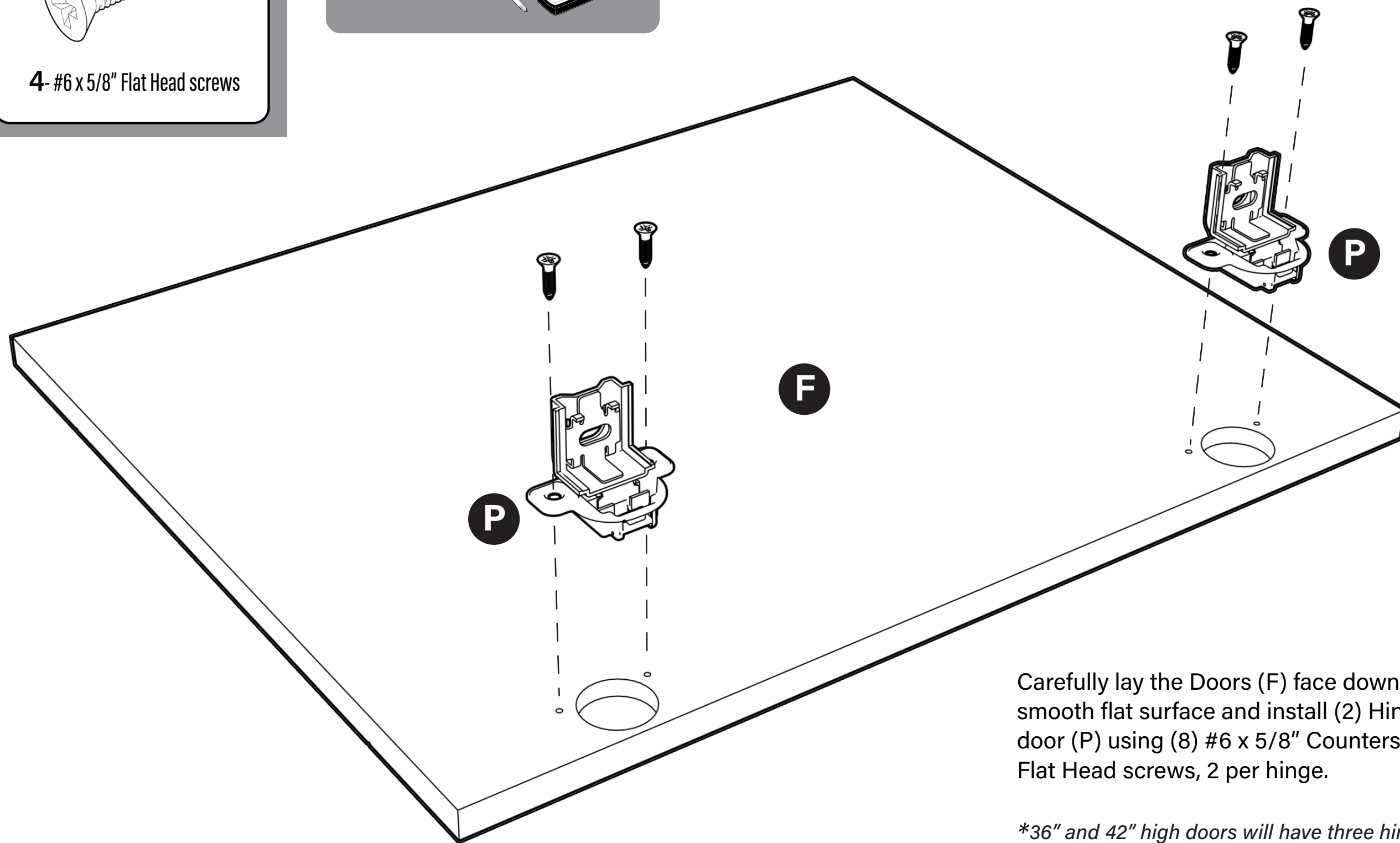
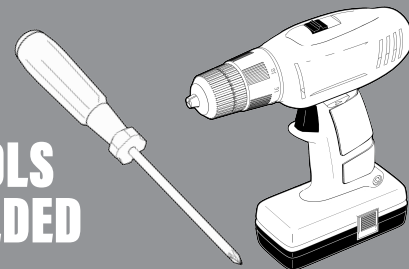

Carefully lay the Doors (F) face down on a smooth flat surface and install (2) Hinges per door (P) using (8) #6 x 5/8" Countersunk Flat Head screws, 2 per hinge.

**36" and 42" high doors will have three hinges each*

STEP 12

Parts List

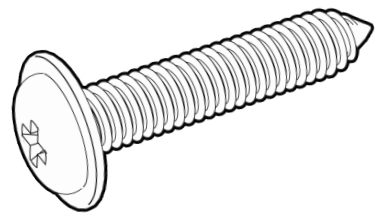

2 - #8 x 1/2" Pan Head Screws

TOOLS NEEDED

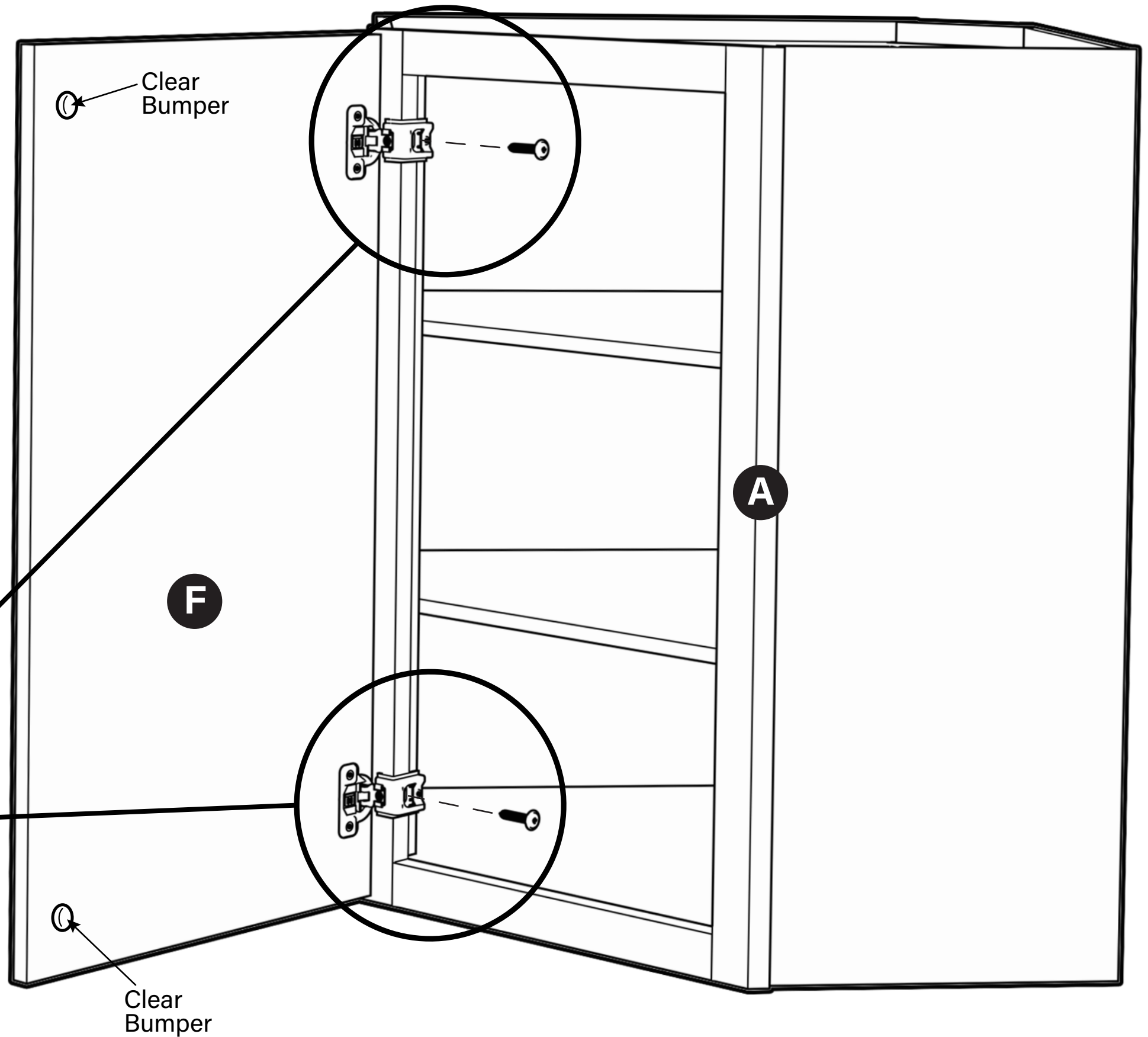
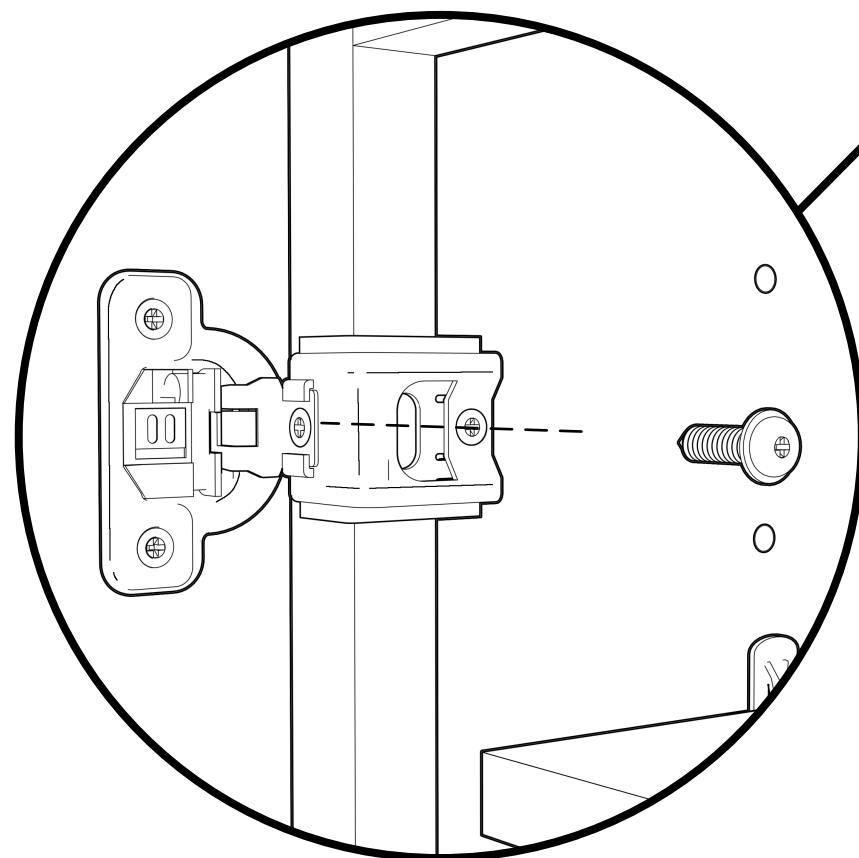
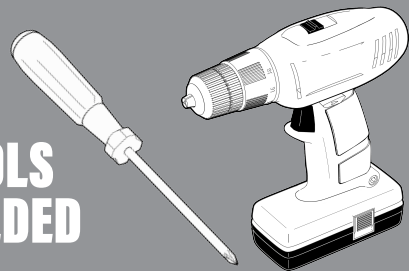

Attach Doors (F) to the Face Frame (A) using (2) #8 x 7/8" Pan Washer Head screws and install (2) Clear Bumpers, 2 on each door.

CONGRATULATIONS

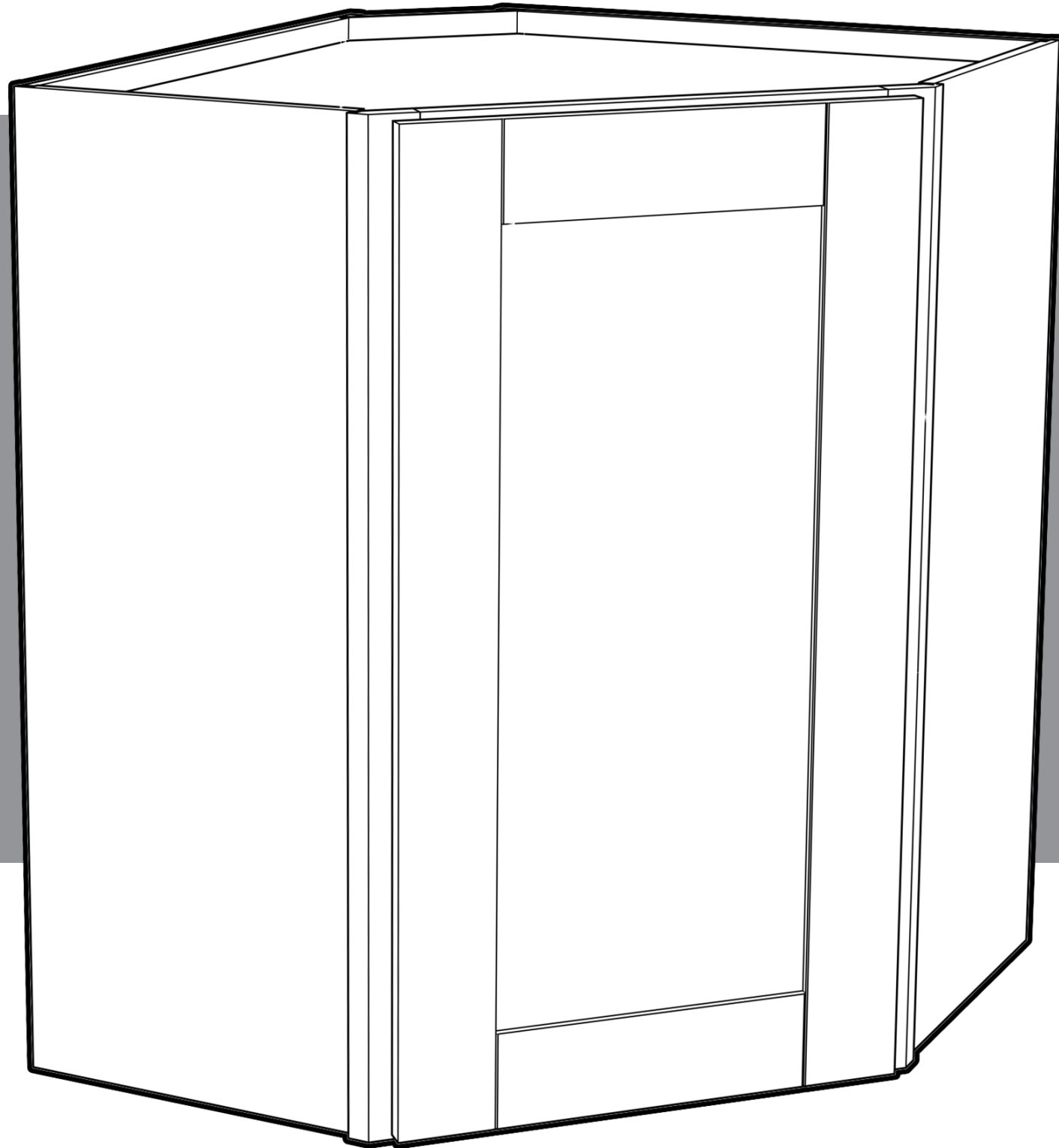

ENJOY!